

INSTRUCTIONS

1. Original and/or subsequent record used to evaluate the corner position.
2. Description of evidence found, note discrepancies in the record, state method of establishing lost or obliterated corners.
3. Description of monument and accessories set to perpetuate the corner position.
4. Sketch of corner, show all pertinent data which can best be shown in a sketch example, corner marking, topography lies, position of accessories, etc.
5. Certification must be signed and sealed by Registered Land Surveyor in State of Montana.
6. Fill in Cross Index & Section Diagram at bottom of sheet.

CERTIFIED CORNER RECORDATION

Corner 24 $\frac{1}{4}$ corner Sec. 25 T. 34N R. 25W P.M.M. Lincoln County

RECORD: 1961 BLM: The $\frac{1}{4}$ sec. cor. of secs. 24 and 25, monumented with a granite stone, 10 x 8 x 4 ins., firmly set and marked $\frac{1}{4}$ on the W. face, and witnessed by one of the original bearing trees.

A larch 16" diam., bears N66W, 76 lks. dist., visible marks BT. (record: N67E, 78 lks.)

Set an iron post, 30 ins. long, 2 $\frac{1}{2}$ ins. diam., 26 ins. in the ground, with brass cap mkd.

T34N R25W

$\frac{1}{4}$ S 24
S 25
1961

FOUND: A 3 $\frac{1}{4}$ " BLM brass cap approx. 3" above ground adjacent to mound of stone.

FROM WHICH:

- A 4" lodgepole pine bears N08W, 24.2 ft., scribing visible.
- A 5" lodgepole pine bears S61E, 32.8 ft., scribing visible.
- A 6" lodgepole pine stump bears S80W, 33.9 ft.
- A 20" larch snag bears N69W, 49.6 ft.

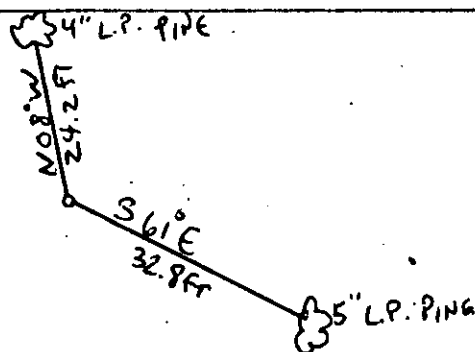
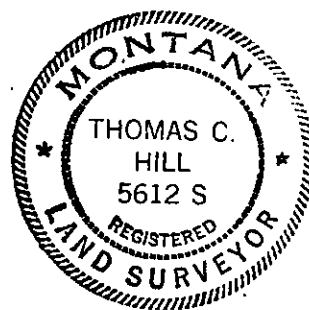
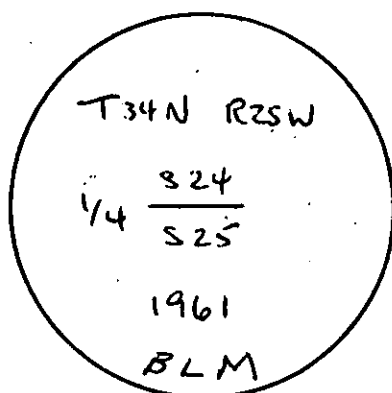

SKETCH OF CORNER

CERTIFICATION

1. JAMES W REED

certify the information shown herein is true and correct.

James W Reed
Signature Ground Party Chief

2. certify that this Corner Record correctly represents work performed by me or under my direction in compliance with the "Corner Recordation Act" (70-22-101, et seq., M.D.A.)

Thomas C Hill
Signature of Surveyor & Seal

Date: 1-27-82 Reg. No. 5612-S

Employer: USFS

Office of Clerk and Recorder, County of Lincoln. This "corner record" was filed for record on the 16th March day of 1982 was noted on the cross-index plat and is assigned page No. 1600, in book No. 1

Eleanor L. Vaughn by Betty L. Conces
County Official deputy

Cross Index No. R-23 T. 34N R. 25W P.M.M.

Sec. 24

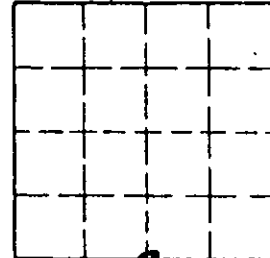

• corner this sheet

