

CERTIFIED CORNER RECORDATION

Corner NW Cor Sec 6 T. 34N R. 25W P.M.M. Lincoln County

1. 1894 G.L.O. Original Record by A.L. Jaqueth et al:

Set:

A post 4 ft. long, 4 ins. square, 24 ins. in the ground for corner to T34 & 35N, R 25 & 26W marked;

T35N, S31 on NE;

R25W, S6 on SE;

T34N, S1 on SW;

R26W, S36 on NW faces with 6 notches on each edge from which;

A Spruce 12 ins. in diam., bears N46°E, 26 lks. dist. marked T35N R25W S31 BT.

A Spruce 8 ins. in diam., bears S80°E, 48 lks. dist. marked T34N R25W S6 BT.

An Aspen 5 ins. in diam., bears S29°W, 158 lks dist. marked T34N R26W S1 BT.

A Spruce 9 ins. in diam., bears N19°W, 38 lks dist. marked T35N R26W S36 BT.

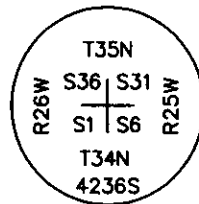

1985 Survey by Robert M. Ryan

Found:

No trace of corner between 2 cultivated fields.

Set:

A brass cap on 2 in. iron pipe mkd. as shown, by single proportion north/south along the Horse creek guide meridian - point falls ± 2' east of n/s fence and ± 79 ft. north of fence corner running n/s/e and ± 11 ft. north of power pole.

2. Found:

A Brass Cap, 2 ins. in diam., on iron rod, 2 ins. in diam., bears N04°16'57"E, 12.12 ft. from our double proportion set position;

3. Set:

A Aluminum Cap, 3¼ ins. in diam., mkd. as shown;

Established:

A Power Pole, bears S84°W, 1.5 ft. dist.;

Incorrect Monument (Cap, 2 ins. in diam.) bears N4°E, 12.1 ft. dist.

Steel posts with LSM decals bear North and South, 2.0 ft. dist.

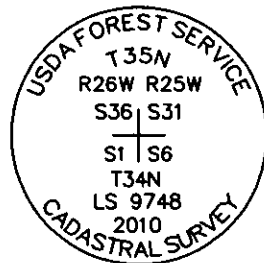

MAGNETIC DECLINATION - 15°2' EAST

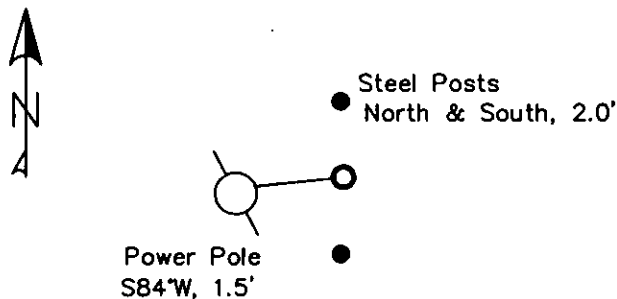

SKETCH OF CORNER

CERTIFICATION

I, Erich Shrack
certify the information shown herein is true and correct.

LAWRENCE A. GLAHE
certify that this Corner Recordation was performed by me or under my supervision in compliance with the "Corner Recordation Act" (Title 26, Chapter 1, of the M.C.A.)

9748 LS

DATE: 12/6/10

EMPLOYER: GLAHE & ASSOC., INC.

Office of Clerk and Recorder, County of Lincoln This "corner

record" was filed for recor

was noted on the cross-i

book No.

230103 BOOK: CCR CC&R'S PAGE: 11702 Pages: 1
STATE OF MONTANA LINCOLN COUNTY
RECORDED: 12/09/2010 11:02 KOI: CC&R'S
TAMMY D. LAUER CLERK AND RECORDER
FEE: \$0.00 BY: *Heather Dwyer*
TO: GLAHE & ASSOC., INC. P.O. BOX 1863, SANDPOINT, ID. 83860
Cross Index No. A-1 T. 34N R. 25W PMM

Adopted July 1, 1981, Montana Board of Professional Engineers & Land Surveyors

| | | | |
|--------|--|--|--|
| Sec. 6 | | | |
| | | | |
| | | | |
| | | | |
| | | | |
| | | | |

● corner this sheet

CERTIFIED COPIES REGISTRATION

State of Illinois, County of Cook, City of Chicago

Notary Public in and for the State of Illinois

I, the undersigned, Notary Public in and for the State of Illinois, do hereby certify that the foregoing is a true and correct copy of the original of the same, as the same appears from the records of the Office of the Notary Public in and for the State of Illinois, at Chicago, Illinois.

Witness my hand and the seal of my Office, at Chicago, Illinois, this _____ day of _____, 19____.

Notary Public in and for the State of Illinois

My Commission Expires _____

Notary Public in and for the State of Illinois

My Commission Expires _____

Notary Public in and for the State of Illinois

My Commission Expires _____

Notary Public in and for the State of Illinois

My Commission Expires _____

Notary Public in and for the State of Illinois

My Commission Expires _____

Notary Public in and for the State of Illinois

My Commission Expires _____

Notary Public in and for the State of Illinois

My Commission Expires _____

Notary Public in and for the State of Illinois

My Commission Expires _____