

CERTIFIED CORNER RECORDATION

Corner C-W-SE-NW 1/256 Sec 6 T. 34N R. 25W P.M.M. Lincoln County

1. NONE

2. NONE

3. Set:

A Aluminum Cap, 3 1/4 ins. in diam., on 5/8 ins. diam. rebar 0.4 ft. above ground, mkd. as shown;

Established:

A Larch, 16 ins. in diam., bears N44°E, 71.9 ft. dist., scribed "C-W-SE-NW 1/256 S6 BT";

A Douglas Fir, 18 ins. in diam., bears N30°W, 74.0 ft. dist., scribed "C-W-SE-NW 1/256 S6 BT";

Steel posts with LSM decals bear North and East, 2.0 ft. dist.



MAGNETIC DECLINATION - 15°2' EAST

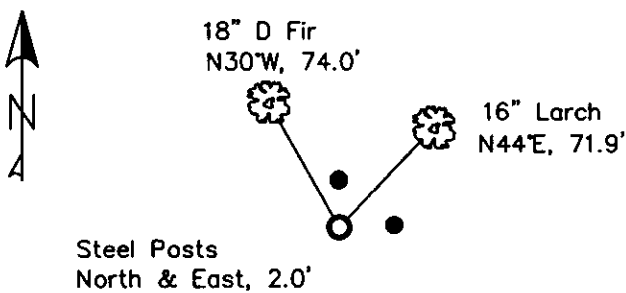

CERTIFICATION

I, Erich Shrack
certify the information shown herein is true and correct.

I, LAWRENCE A. GLAHE
certify that this Corner Recordation correctly represents work performed by me or under my direction in compliance with the "Corner Recordation Act" (MCA, 82-101, et seq.)

Date: 12/10/2010 9748 LS
Employer: GLAHE & ASSOC., INC.

SKETCH OF CORNER

Office of Clerk and Recorder, County of Lincoln. This "corner
record" was filed for record 230099 BOOK: CCR CC&R'S PAGE: 11698 Pages: 1
was noted on the cross STATE OF MONTANA LINCOLN COUNTY
book No. TAMMY D. LAUER CLERK AND RECORDER
FEE: \$0.00 BY: [Signature]
TO: GLAHE & ASSOC., INC. P.O. BOX 1863, SANDPOINT, ID. 83860

Cross Index No. C-3 T. 34N R. 25W PMM

Adopted July 1, 1981, Montana Board of Professional Engineers & Land Surveyors

Sec. 6

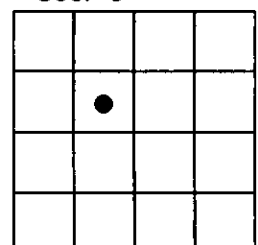

● corner this sheet

CERTIFICATE OF ADOPTION

OF THE CONSTITUTION OF THE UNITED STATES OF AMERICA

IN WITNESS WHEREOF, the undersigned, being the duly authorized officers of the said organization, have hereunto set their hands and seals at the city of New York, this 1st day of January, 1901.

Attest: _____
Secretary

100-100000

100-100000

100-100000