

CERTIFIED CORNER RECORDATION

Corner C-E-SW 1/64th Cor Sec 7 T. 34N R. 25W P.M.M. Lincoln County

1. NONE

2. NONE

3. Set:

An Aluminum Cap, 3 1/4 ins. diam., on a 5/8 ins. Rebar, mkd. as shown;

Established:

A Douglas Fir, 14 ins. in diam., bears N26°E, 23.7 ft. dist., scribed "C-E-SW 1/64 S7 BT";

A Douglas Fir, 11 ins. in diam., bears S86°E, 32.4 ft. dist., scribed "C-E-SW 1/64 S7 BT";

Steel posts with decals bear South and North, 2.0 ft. dist.



MAGNETIC DECLINATION - 15°2' EAST

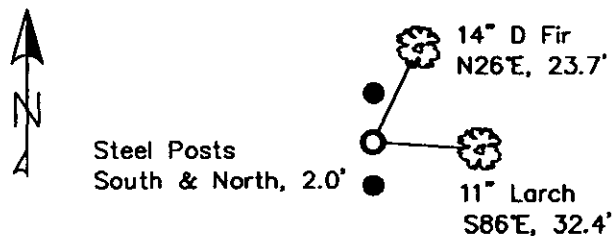

CERTIFICATION

I, Erich Shrock
certify the information above is true and correct.
Signature of Party

LAWRENCE A. GLAHE
certify that the Corner is a landmark represents work
performed by me or under my direction in compliance with
the "Corner Recordation Act" (MCA 10-22-101, et seq.)
9748 LS
Date: 12-6-10
Employer: GLAHE & ASSOC., INC.

SKETCH OF CORNER

Office of Clerk and Recorder, County of Lincoln This "corner
230083 BOOK: CCR CC&R'S PAGE: 11682 Pages: 1
record" was filed for record STATE OF MONTANA LINCOLN COUNTY
was noted on the cross-indexed RECORDED: 12/09/2010 10:42 KOI: CC&R'S
book No. TAMMY D. LAUER CLERK AND RECORDER
FEE: \$0.00 BY: Lawrence A. Glahe
TO: GLAHE & ASSOC., INC. P.O. BOX 1863, SANDPOINT, ID. 83860

H-2
Cross Index No. H-3 T. 34N R. 25W PMM

Adopted July 1, 1981, Montana Board of Professional Engineers & Land Surveyors

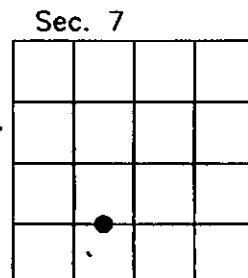

● corner this sheet



11/11/11

11/11/11