

CERTIFIED CORNER RECORDATION

Corner C-S-SE 1/64th Cor Sec 7 T. 34N R. 25W P.M.M. Lincoln County

1. NONE

2. Found:

A 5/8 ins. rebar with yellow plastic cap mkd. #7328S

3. Set:

Replaced yellow plastic cap with an Aluminum Cap, 3 1/4 ins. diam., on the 5/8 ins. Rebar, mkd. as shown;

Established:

A Spruce, 6 ins. in diam., bears N78°W, 58.8 ft. dist., scribed "C-S-SE 1/64 S7 BT";

A Spruce, 12 ins. in diam., bears N19°W, 40.2 ft. dist., scribed "C-S-SE 1/64 S7 BT";

Steel posts with decals bear North and East, 2.0 ft. dist.



MAGNETIC DECLINATION - 15°2' EAST

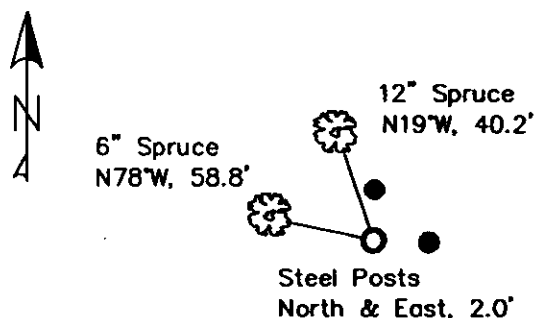

SKETCH OF CORNER

CERTIFICATION

I, Erich Strook
certify the information above herein is true and correct.

LAWRENCE A. GLAHE
certify that this Corner Recordation Survey represents work performed by me or under my supervision in compliance with the "Corner Recordation Act" (MCA 82-401, et seq.)

9748 LS

Date: 12-10-10

Employer: GLAHE & ASSOC., INC.

Office of Clerk and Recorder, County of Lincoln, This "corner

record" was filed for re 230081 BOOK: CCR CC&R'S PAGE: 11680 Pages: 1

STATE OF MONTANA LINCOLN COUNTY

was noted on the cross RECORDED: 12/09/2010 10:40 KOI: CC&R'S

book No. TAMMY D. LAUER CLERK AND RECORDER

FEE: \$0.00 BY: Lawrence A. Glahe
TO: GLAHE & ASSOC., INC. P.O. BOX 1863, SANDPOINT, ID. 83860,

H-4

Cross Index No. J-4 T. 34N R. 25W P.M.M.

Adopted July 1, 1981, Montana Board of Professional Engineers & Land Surveyors

Sec. 7

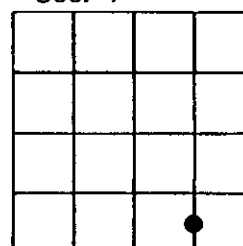

● corner this sheet

1000

1000