

CERTIFIED CORNER RECORDATION

Corner W 1/4 Cor Sec 6 T. 34N R. 25W P.M.M. Lincoln County

1. 1893 Original GLO by A.L. Jaqueth et al:

Set:

A Limestone, 13x10x6 ins., 9 ins. in the ground, mkd. 1/4 on West face;

From which:

A Tamarack, 28 ins. diam., bears S43°E, 30 lks. dist., mkd. 1/4 S BT;

A Tamarack, 28 ins. diam., bears N63°W, 24 lks. dist., mkd. 1/4 S BT;

1961 BLM Remonumentation by Cunningham & Stephens

Set:

An iron post, 30 ins. long, 2 1/2 ins. in diam., 28 in the ground, in concrete, with
A Brass Cap mkd. as shown;

From which the remains of the original bearing trees:

A Stump, 30 ins. in diam., bears S40 1/4°E, 31 lks. dist., visible marks BT.

A Stump, 30 ins. in diam., bears N65 1/4°W, 24 lks. dist., visible marks BT;

Established:

A Fir, 8 ins. diam., bears S12 1/2°E, 103 lks. dist., mkd. 1/4 S6 BT;

A Larch, 8 ins. diam., bears S71 1/4°W, 63 lks. dist., mkd. 1/4 S1 BT;

Raised a mound of stone, 3 ft. base, 2 ft. high, West of the iron post.

1984 by Robert M. Ryan:

Used BLM Remonumentation records from 1961;

Found:

A Brass Cap in rock mound ± 1.0 ft. South and ± 1.0 ft. East of fence corner running north, south & east at southwest corner of hayfield.

A Tamarack, 11 ins. in diam., bears S71°11'W, 41.4 ft. dist.;

A Fir, 15 ins. in diam., bears S12°18'E, 68.0 ft. dist.

1996 by Alvah F. Hughes:

Found:

A Brass Cap, 3 1/4 ins. in diam., flush with ground, mkd. as shown;

A Stump, 25 ins. in diam., bears S39°E, 21.4 ft. dist. mkd. with visible scribing;

A Fir, 17 ins. in diam., bears S12 1/2°E, 68.3 ft. dist., mkd. with healed face;

A Larch, 11 ins. in diam., bears S72°W, 41.6 ft. dist., mkd. with healed face;

A Stump, 28 ins. in diam., bears N63°W, 17.0 ft. dist., with no visible marks;

2. Found:

A BLM Brass Cap, 3 1/4 ins. in diam., flush with ground, mkd. as shown;

A Douglas Fir, 19 ins. in diam., bears S12°18'E, 68.0 ft. dist., healed face,

A Larch, 11 ins. in diam., bears S72°W, 41.3 ft. dist. healed face;

A BT stump, bears S40 1/4°E, 20.0 ft. dist., visible scribe.

3. Stacked and painted a mound of rock around monument;

Painted blazes and bands on all BTs; Replaced tag and sign where needed.

MAGNETIC DECLINATION - 15°4' EAST

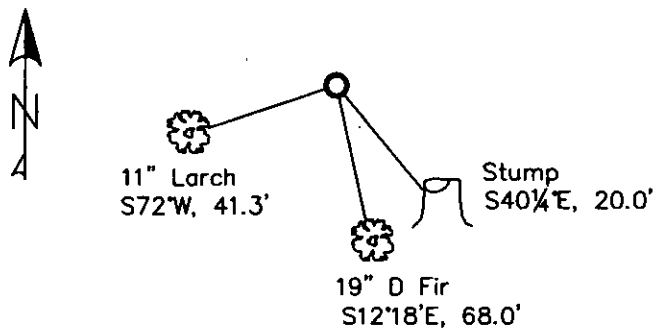

SKETCH OF CORNER

CERTIFICATION

I, Erich Shrack
certify the information shown herein is true and correct.

Signature of Ground Party

I, LAWRENCE A. GLAHE
certify that this Corner Recordation was performed by me or under my direction in compliance with the "Corner Recordation Act" (MCA 16-22-401, et seq.)

Signature of Surveyor

Date 11-10-10 9748 LS

Employer: GLAHE & ASSOC., INC.

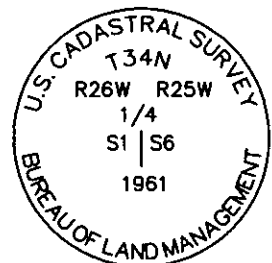

Office of Clerk and Recorder, County of Lincoln. This "corner

record" was filed for re. 229598 BOOK: CCR CC&R'S PAGE: 11583 Pages: 1

was noted on the cross STATE OF MONTANA LINCOLN COUNTY

book No. RECORDED: 11/15/2010 11:10 KOI: CC&R'S

TAMMY D. LAUER CLERK AND RECORDER

FEE: \$0.00 BY: [Signature]

TO: GLAHE & ASSOC., INC. P.O. BOX 1863, SANDPOINT, ID. 83860,

Cross Index No. C-1 T. 34N R. 25W PMM

Adopted July 1, 1981, Montana Board of Professional Engineers & Land Surveyors

Sec. 6

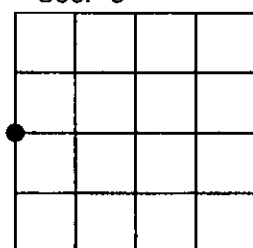

● corner this sheet

