

CERTIFIED CORNER RECORDATION

Corner SE Cor Sec 7 T. 34N R. 25W P.M.M. Lincoln County

1. 1894 G.L.O. Original Record by A.L. Jaqueth et al

Set:

A post 4 ft. long, 4 ins. square, 24 ins. in the ground for cor to Secs. 7, 8, 17 & 18, mkd. T34N S8 on NE, R25W S17 on SE, S18 on SW and S7 on NW faces with 4 notches on South and 5 notches on E edges,

From which:

A Pine, 16 ins. in diam., bears N30°15'E, 92 lks. dist., mkd. T34N R25W S8 BT;

A Fir, 8 ins. in diam., bears S84°E, 325 lks. dist., mkd. T34N R25W S17 BT;

A Pine, 14 ins. in diam., bears N4°W, 83 lks. dist., mkd. T34N R25W S7BT.

Dug a pit 18x18x12 ins. Southwest, 5½ feet dist. from post, raised a mound of earth around 2 ft. high, 4½ ft. around post.

1960 BLM Remonumentation by Cunningham & Stephens

The cor. of secs. 7, 8, 17 and 18 as determined from the remains of two of the original BTs.

Found:

A Stump, 22 ins. diam., bears N33°E, 92 lks. dist., visible marks BT;

A Stump, 14 ins. diam., bears S82¼°E, 325 lks. dist., visible marks BT;

Set:

An Iron post, 30 ins. long, 2½ ins. diam., 26 ins. in the ground, with

A Brass cap, mkd. as shown:

A Fir, 6 ins. in diam., bears N52¼°E, 169 lks. dist., mkd. T34N R25W S8 BT;

A Fir, 9 ins. in diam., bears S82 3/4°E, 337 lks. dist., mkd. T34N R25W S17 BT;

An Aspen, 8 ins. in diam., bears N24¼°W, 101 lks. dist., mkd. T34N R25W S7 BT;

1992 by Ronald Pearson, 9008LS

Found:

A BLM Brass Cap on a 2½ ins. diam. pipe, 2 ins. out of the ground, mkd. as shown;

A Root crown, bears N30°E, 60.2 ft. dist.,

A Fir, 15 ins. in diam., bears N53°E, 112.0 ft. dist., healed face;

A Fir, 14 ins. in diam., bears S82°E, 223.00 ft. dist., healed face;

An Aspen, 11 ins. in diam., bears N19°W, 67.9 ft. dist., healed face;

A Stump, 16 ins. in diam., bears N4°W, 55.0 ft. dist.

Set:

A Steel guard post, 6 ft. long with LSM & PB decals, bears North, 3 ft. dist.

2. Found:

A BLM Brass Cap, 3¼ ins. in diam., flush with ground, mkd. as shown;

A Douglas Fir, 21 ins. in diam., bears N53°E, 112.0 ft. dist., with healed face,

A Douglas Fir, 17 ins. in diam., bears S82°E, 223.0 ft. dist., visible scribe;

An Aspen, 16 ins. in diam., bears N19°W, 67.9 ft. dist., healed face;

A Steel Post with LSM decal, bears North, 3 ft. dist.

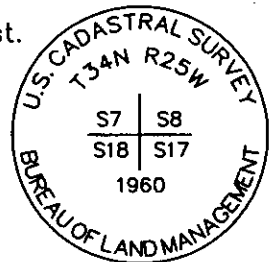

3. Placed and painted a mound of rock around monument; Painted blazes and bands on all BTs; Replaced tags & signs as needed;

MAGNETIC DECLINATION - 15°4' EAST

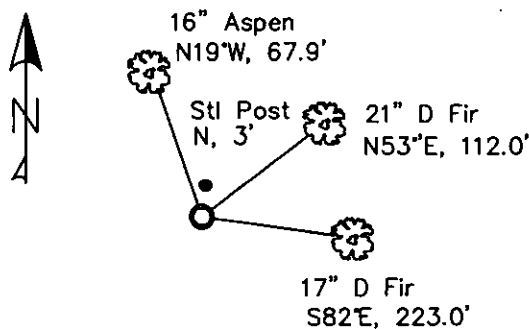

SKETCH OF CORNER

CERTIFICATION

I, Erich Shrack
certify the information shown herein is true and correct.

LAWRENCE A. GLAHE
I, LAWRENCE A. GLAHE, a duly Licensed Professional Engineer, certify that this Corner Recordation was performed by me or under my supervision in compliance with the "Corner Recordation Act" (MCA 22-2-401, et seq. M.C.A.)

Date: 11-10-10 9748 LS
Employer: GLAHE & ASSOC., INC.

Office of Clerk and Recorder, County of Lincoln. This "corner

record" was filed 229593 BOOK: CCR CC&R'S PAGE: 11578 Pages: 1

was noted on the STATE OF MONTANA LINCOLN COUNTY

book No. TAMMY D. LAUER CLERK AND RECORDER

FEE: \$0.00 BY: Leanne Davis Deputy

TO: GLAHE & ASSOC., INC. P.O. BOX 1863, SANDPOINT, ID. 83860,

Cross Index No. J-5 T. 34N R. 25W PMM

Adopted July 1, 1981, Montana Board of Professional Engineers & Land Surveyors

Sec. 7

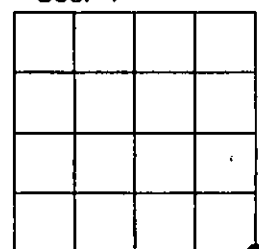

● corner this sheet

