

# CERTIFIED LAND CORNER RECORDATION

## DESCRIPTION OF CORNER EVIDENCE FOUND, AND ORIGINAL RECORD (IF KNOWN)

FOUND STONE MARKED '6 H.E.S. 333' (X) ON EAST FACE  
 CORNER \*6, H.E.S. \*333, S.29 T34N R24W  
 RECORD; STONE 25X10X6 INS. 15 INS. IN GROUND MARKED  
 '6 H.E.S. 333' ON N. FACE, WITH (X) ON TOP  
 BT'S  
 SPRUCE 12" DIA. WITH (X) N 65° 15' E 10 LKS.  
 SPRUCE 14" DIA. WITH (X) S 76° 35' W 13 LKS.  
 RAISE A MOUND OF EARTH, 4 FT. BASE 2 FT HIGH N. OF CORNER

## DESCRIPTION OF MONUMENT AND ACCESSORIES ESTABLISHED TO PERPETUATE THE ORIGINAL LOCATION OF THIS CORNER:

MONUMENT IS ORIGINAL STONE Date of work: 8/23/86  
 MARKED '6 HES. 333' (X) ON E. FACE  
 TWO ACCESSORY BEARING TREES HAVE BEEN ESTABLISHED

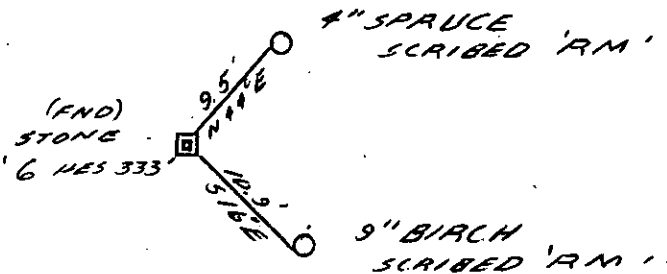

SKETCH, WITH COURSE AND DISTANCE TO ADJACENT CORNERS IF DETERMINED IN THIS SURVEY.  
 (MAY SKETCH OR PASTE REPRODUCTION ON REVERSE SIDE.)

SEE CERT. OF SURVEY #1501

## DIAGRAM OF CORNER:

Surveyor's Seal

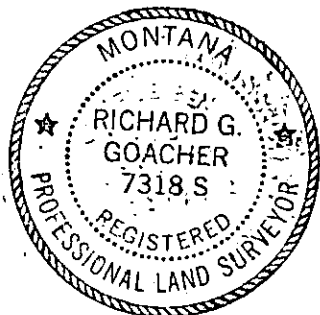

I, \_\_\_\_\_  
 certify that the information shown herein is true and correct.

N.

Signature of Ground Party Chief

I, RICHARD G. GOACHER  
 certify that I have carefully performed or reviewed the work  
 done on the diagrammed corner as reported on this recordation  
 form and approve the same.

COR 6  
 HES 333

= Corner recorded on the sheet

Signature of Surveyor

7318-S

Registration Number

Office of Clerk and Recorder, County of Lincoln

This "corner record" was filed for record on the 16 day of Dec 19 87, was noted on the cross-index plat and is  
 assigned page No. 3787, in book No. \_\_\_\_\_

Janet B. Sigley  
 County Official Dep.

