

CERTIFIED LAND CORNER RECORDATION

DESCRIPTION OF CORNER EVIDENCE FOUND, AND ORIGINAL RECORD (IF KNOWN)

FOUND UPRIGHT STONE MARKED 'CORNER #2 H.E.S. 333, FOUND STUMP
N 16° E 15.8' NO VISIBLE SCRIBING.

RECORD; 24x18x6 STONE MARKED 2 H.E.S. 333 (X) ON TOP

BT'S

LARCH 28" DIA. MARKED (X) N 91° 55' E 24 LKS.

LARCH 28" DIA. MARKED (X) S 68° 48' E 80 LKS.

CORNER #2 - H.E.S. #333 - W 1/2 S. 29, T34N R24W

DESCRIPTION OF MONUMENT AND ACCESSORIES ESTABLISHED TO PERPETUATE THE ORIGINAL LOCATION OF THIS CORNER:

MONUMENT IS ORIGINAL STONE MARKED '2 H.E.S. 333'. TWO ACCESSORY BEARING TREES HAVE
BEEN ESTABLISHED. Date of work: 8/23/86

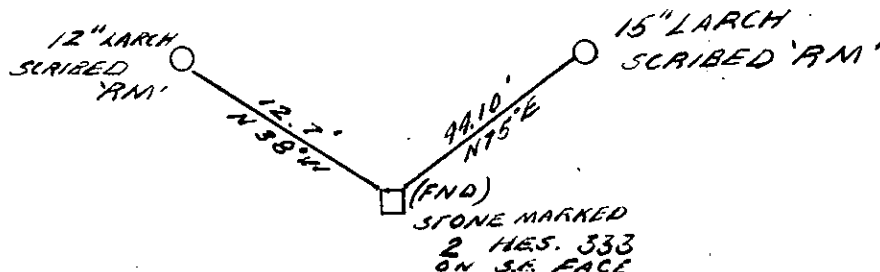

SKETCH, WITH COURSE AND DISTANCE TO ADJACENT CORNERS IF DETERMINED IN THIS SURVEY.
(MAY SKETCH OR PASTE REPRODUCTION ON REVERSE SIDE.)

See Cert. of Survey # 1501

DIAGRAM OF CORNER:

Surveyor's Seal

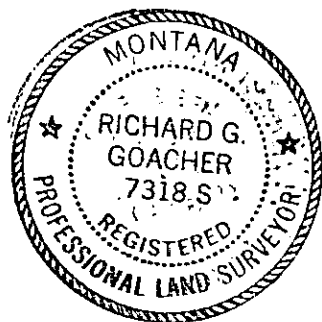

I, _____
certify that the information shown herein is true and correct.

Signature of Ground Party Chief

I, RICHARD G. GOACHER
certify that I have carefully performed or reviewed the work
done on the diagrammed corner as reported on this recordation
form and approve the same.

[Signature]

Signature of Surveyor

7318-S

Registration Number

N.

COR. 2
HES 333

= Corner recorded on the sheet

Office of Clerk and Recorder, County of Lincoln

This "corner record" was filed for record on the 16 day of Dec 19 87, was noted on the cross-index plat and is
assigned page No. 3785, in book No. _____

[Signature]
County Official

Cross Index No. _____ T _____ R _____ Mer.

THE UNITED STATES OF AMERICA
DEPARTMENT OF THE INTERIOR
BUREAU OF LAND MANAGEMENT

WYOMING
SANDWICH MOUNTAIN
NATIONAL MONUMENT

ESTABLISHED BY PROCLAMATION
JANUARY 10, 1936
BY H. H. HOOVER, DIRECTOR

BY PROCLAMATION
JANUARY 10, 1936
BY H. H. HOOVER, DIRECTOR

WHEREAS, certain public lands within the
Sandwich Mountain National Monument
are situated in the State of Wyoming



BY PROCLAMATION
JANUARY 10, 1936
BY H. H. HOOVER, DIRECTOR

BY PROCLAMATION
JANUARY 10, 1936
BY H. H. HOOVER, DIRECTOR

BY PROCLAMATION
JANUARY 10, 1936
BY H. H. HOOVER, DIRECTOR