

# CERTIFIED LAND CORNER RECORDATION

## DESCRIPTION OF CORNER EVIDENCE FOUND, AND ORIGINAL RECORD (IF KNOWN)

CORNER NOT FOUND. FOUND STUMP N 73° E 33.0' NO SCRIBING.  
FOUND STUMP S 20° E 3.96' SCRIBING VISIBLE

RECORD; SANDSTONE 24" X 6" 14 INS IN GROUND MARKED  
" H.E.S 333 ON E. FACE (X) ON TOP

BT'S

LARCH 20" DIA. (X) S 15° 40' E 6 LKS.

SPRUCE 4" DIA (X) N 71° 35' E 50 LKS. SCRIBED  
MOUND 4' BASE 2' HIGH E. OF CORNER

CORNER #1 - H.E.S. #333 - W 1/2 S. 29, T 34 N R 24 W

## DESCRIPTION OF MONUMENT AND ACCESSORIES ESTABLISHED TO PERPETUATE THE ORIGINAL LOCATION OF THIS CORNER:

SET 5/8" X 24" REBAR WITH PLASTIC CAP. Date of work: 8/23/86  
MARKED GOACHER 7318-S; FROM ORIG. B.T.'S  
TWO ACCESSORY BEARING TREES ESTABLISHED

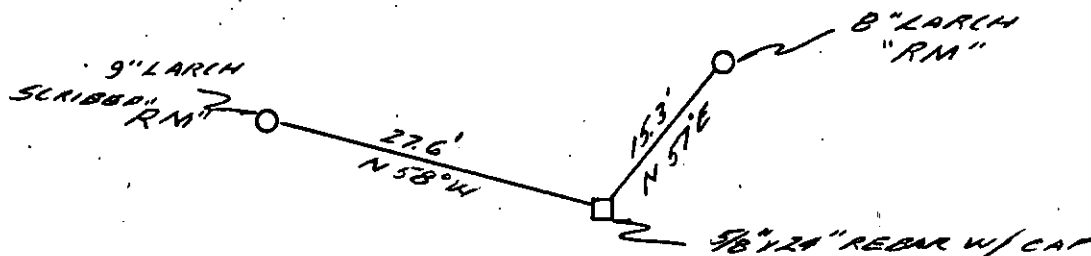

SKETCH, WITH COURSE AND DISTANCE TO ADJACENT CORNERS IF DETERMINED IN THIS SURVEY.  
(MAY SKETCH OR PASTE REPRODUCTION ON REVERSE SIDE.)

SEE CERT. OF SURVEY #1501

## DIAGRAM OF CORNER:

Surveyor's Seal

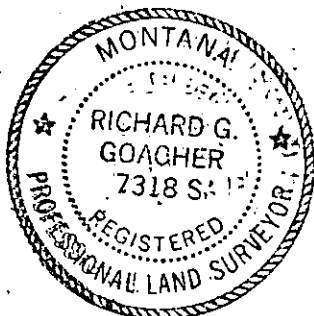

I, \_\_\_\_\_  
certify that the information shown herein is true and correct.

Signature of Ground Party Chief

I, RICHARD G. GOACHER  
certify that I have carefully performed or reviewed the work  
done on the diagrammed corner as reported on this recordation  
form and approve the same.

[Signature]  
Signature of Surveyor

7318-S

Registration Number

N.

COR. 1  
HES 333

= Corner recorded on the sheet

Office of Clerk and Recorder, County of Lincoln

This "corner record" was filed for record on the 16 day of Dec 19 87, was noted on the cross-index plat and is  
assigned page No. 3784, in book No. \_\_\_\_\_

[Signature]  
County Official

