

# CERTIFIED LAND CORNER RECORDATION

## DESCRIPTION OF CORNER EVIDENCE FOUND, AND ORIGINAL RECORD (IF KNOWN)

FOUND: 2" BRASS CAP, 24" ABOVE GROUND, STAMPED "GLO 1919  
1/4 S 30/29

RECORD: IRON POST 3' LONG, 1" DIAM, 24" ABOVE GROUND

BT'S: CEDAR, 16" BEARS N. 34 1/2° E. 17 IKS. DIST., MKD. 1/4 S 29 BT  
CEDAR, 10" BEARS S. 36 1/2° W 13 IKS. DIST., MKD. 1/4 S 30 BT  
NOT FOUND, BT'S

## DESCRIPTION OF MONUMENT AND ACCESSORIES ESTABLISHED TO PERPETUATE THE ORIGINAL LOCATION OF THIS CORNER:

Date of work: 8-23-86

FOUND ORIGINAL B.C. MON.

8" LODGEPOLE PINE

ATTACHED BT TAGS, FOOT  
BLAZE SCRIBED R.M.,  
PAINTED RED

N. 10° W  
20.0'

S 83° E  
29.3'

8" LODGEPOLE PINE

## SKETCH, WITH COURSE AND DISTANCE TO ADJACENT CORNERS IF DETERMINED IN THIS SURVEY. (MAY SKETCH OR PASTE REPRODUCTION ON REVERSE SIDE.)

19 | 20  
30 | 29  
N 100° 10' 06" E  
2658.77'  
50 | 29  
14

CORNER RECORDED THIS  
CORNER

## DIAGRAM OF CORNER:

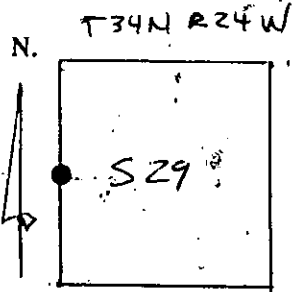

● = Corner recorded on the sheet

Surveyor's Seal

I, \_\_\_\_\_  
certify that the information shown herein is true and correct.

Signature of Ground Party Chief

I, RICHARD G. GOACHER  
certify that I have carefully performed or reviewed the work  
done on the diagrammed corner as reported on this recordation  
form and approve the same.

Signature of Surveyor

7318-S

Registration Number

Office of Clerk and Recorder, County of Lincoln

This "corner record" was filed for record on the 16 day of Dec 19 87, was noted on the cross-index plat and is  
assigned page No. 3783, in book No. \_\_\_\_\_

Janet B. Sugilby  
County Official

