

CERTIFIED CORNER RECORDATION

Corner NE-SE 1/64 Sec. 9 T. 33N R. 34W P.M., MT Lincoln County

- I. 1996 Plat No. 5742 of Munyan Subdivision by Ken E. Davis, 4975S: Set by survey, a 5/8 in. diam. rebar, with a 1 1/4 in. diam. plastic cap, stamped "KED 4975S". Established two bearing trees.
- II. Found a 5/8 in. diam. rebar, with a yellow plastic cap, mkd. "KED 4975S". Found both of the bearing trees set by Davis.
from which:
A fir, 14 ins. diam., bears S25°W, 33.9 ft. dist., mkd. "NE-SE 1/64 S9 BT".
A fir, 14 ins. diam., bears N56°W, 9.9 dist., mkd. "NE-SE 1/64 S9 BT".
- III. Accepted the position of the found rebar, at the corner position, set an aluminum pipe, 30 ins. long, 2 1/2 in. diam., 26 ins. in the ground, with a 3 1/4 in. diam. aluminum cap mkd. as shown. Buried the found rebar inside the aluminum pipe. Surrounded by a rock collar.

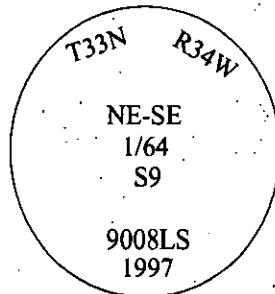

Painted bearing trees and attached Land Survey Monument and Bearing Tree signs.

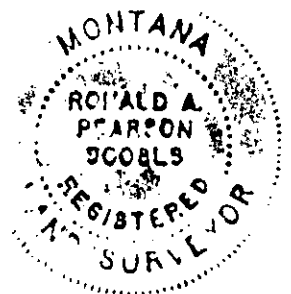

Magnetic Declination: 20° East.

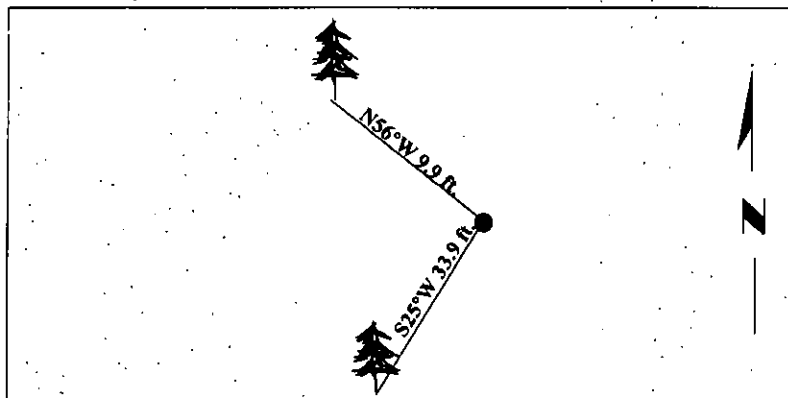

SKETCH OF CORNER

CERTIFICATION	
I. <u>Thomas Hommel</u>	certify the information shown herein is true and correct.
I. <u>Ronald A. Pearson</u>	
certify that this Corner Record correctly represents work performed by me or under my direction in compliance with the "Corner Recordation Act" (70-22-101, et seq., M.C.A.)	
<u>Ronald A. Pearson</u> Signature of Surveyor & Seal	
Date: <u>06/04/97</u>	
Reg. No.: <u>9008LS</u>	
Employer: <u>U.S. FOREST SERVICE</u>	

Office of Clerk and Recorder, County of LINCOLN. This "corner record" was filed for record on JULY 31, 1997 was noted on the cross-index plat and is assigned page No. 9863 in book No. _____

CORAL M. CUMMINGS
County Official

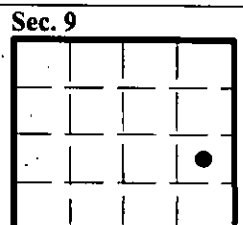

• - corner this sheet