

# CERTIFIED CORNER RECORDATION

Corner 1/4 Sec. 9&16 T. 33N R. 34W P.M., MT Lincoln County

I. 1903 G.L.O. Original record by Allen B. Benedict: Set a limestone, 24x10x3 ins., 18 ins. in the ground, for 1/4 sec. cor. mkd. "1/4" on the N. face. jEstablished two bearing trees.

1966 B.L.M. Remonumentation record by Joseph E. French et. al: The 1/4 sec. cor. of secs. 9 and 16, as determined from the remains of the original bearing trees. At the corner point, set an iron post, 30 ins. long 2 1/2 ins. diam., 24 ins. in the ground, with the brass cap mkd. as shown:

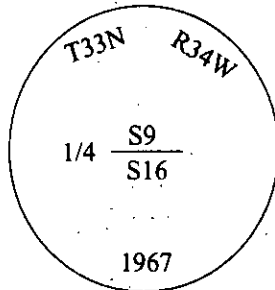

Established two new bearing trees:

A fir, 7 ins. diam., bears S76 1/2°W, 271 lks. dist., mkd. "1/4 S16 BT".

A fir, 9 ins. diam., bears N50 1/2°W, 63 lks. dist., mkd. "1/4 S9 BT".

II. Found a 2 1/2 in. diam. iron pipe, firmly set, protruding 6 ins. above the ground, with a 3 1/4 in. diam. B.L.M. brass cap, mkd. as shown above.

from which:

A stump, 16 ins. diam., bears S50°E, 22.7 ft. dist., mkd. "1/4 S16 BT". (GLO-record-S52°E)

A fir, 19 ins. diam., bears N43°W, 42.3 ft. dist., with a healed face. (BLM-record-N50 1/2°W)

III. Established one new bearing tree:

A larch, 12 ins. diam., bears S52°W, 138.4 ft. dist., mkd. "1/4 S16 BT".

Painted bearing trees and attached Land Survey Monument and Bearing Tree signs.

Magnetic Declination: 20° East.

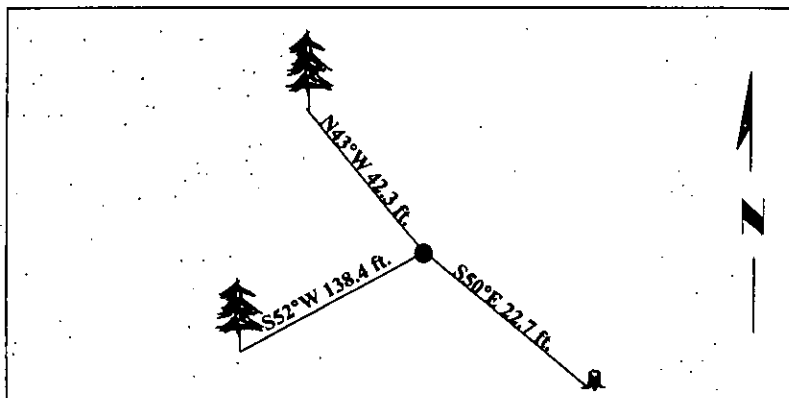
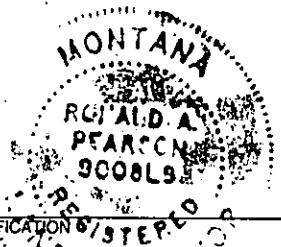

SKETCH OF CORNER

I. Thomas Hommel

certify the information shown herein is true and correct.

I. Ronald A. Pearson

certify that this Corner Record correctly represents work performed by me or under my direction in compliance with the "Corner Recordation Act" (70-22-101, et seq., M.C.A.)

*[Signature]*

Signature of Surveyor & Seal

Date: 06/04/97

Reg. No.: 9008LS

Employer: U.S. FOREST SERVICE

Office of Clerk and Recorder, County of LINCOLN. This "corner record" was filed for record on JULY 31, 1997 was noted on the cross-index plat and is assigned page No. 9860 in book No. CORAL M. CUMMINGS

County Official *[Signature]*

Sec. 16

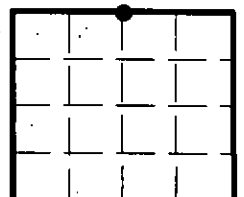

• - corner this sheet

Cross Index No. J-11 T. 33N R. 34W P.M. MT