

CERTIFIED CORNER RECORDATION

Corner CS 1/16 Sec. 4 T. 33N R. 34W P.M., MT Lincoln County

- I. 1981 Certified Corner Recordation by Jack H. Ninneman, Registration No. 4661S: Set by survey, a 5/8 in. diam. x 24 ins. long, capped steel pin, stamped "J.H.N. 4661S". Established two bearing trees.
- II. Found a 5/8 in. diam. rebar, firmly set, protruding 2 ins. above the ground, with a yellow plastic cap, mkd. "4661S".

from which:
A larch, 13 ins. diam., bears N52°E, 15.9 ft. dist., with a healed face. (1981-record-N46°E)
A larch, 15 ins. diam., bears S52°W, 23.1 ft. dist., with a healed face. (1981-record)
- III. Accepted the position of the found rebar, set in its place, an aluminum pipe, 30 ins. long, 2 1/2 in. diam., 24 ins. in the ground, with a 3 1/4 in. diam. aluminum cap, mkd. as shown below.

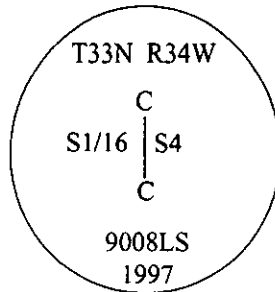

Buried the found rebar inside the aluminum pipe.

Set a 6 ft. steel guard post, West, on property line, 3.0 ft. dist. from the corner, with Land Survey Monument and Property Boundary decals attached.

Painted bearing trees and attached Land Survey Monument and Bearing Tree signs.

Magnetic Declination: 20° East.

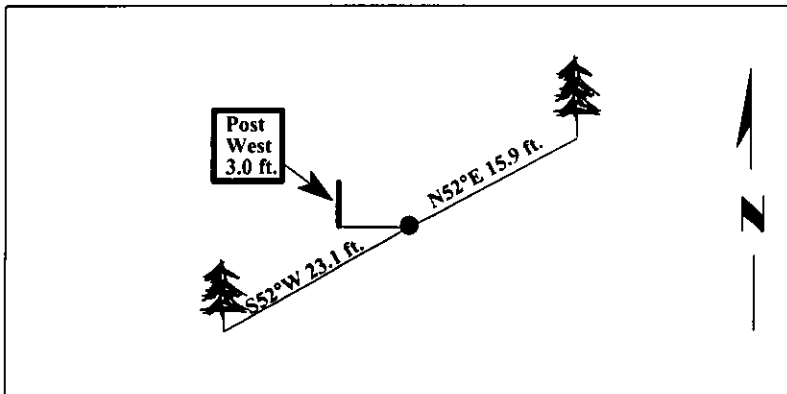
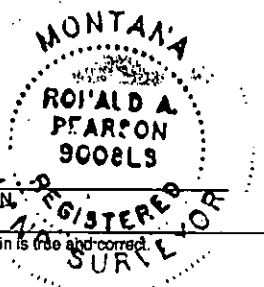

SKETCH OF CORNER

CERTIFICATION
I, Thomas Hommel
certify the information shown herein is true and correct.

I, Ronald A. Pearson
certify that this Corner Record correctly represents work performed by me or under my direction in compliance with the "Corner Recordation Act" (70-22-101, et seq., M.C.A.)

Signature of Surveyor & Seal
Date: 06/10/97
Reg. No.: 9008LS
Employer: U.S. FOREST SERVICE

Office of Clerk and Recorder, County of LINCOLN. This "corner record" was filed for record on JULY 31, 1997 was noted on the cross-index plat and is assigned page No. 9859 in book No. _____

CORAL M. CUMMINGS
County Official

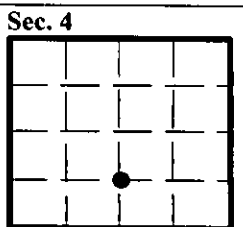

• - corner this sheet