

CERTIFIED CORNER RECORDATION

Corner 1/4 Sec. 4&33 T. 33&34N R. 34W P.M., MT Lincoln County

I. 1903 G.L.O. Original Record by Allen B. Benedict: Set a granite stone, 15X10X4 ins., 10 ins. in the ground for 1/4 sec. cor. mkd. "1/4" on the N. face. Established two bearing trees.

1980 Certified Corner Recordation by Thomas C. Hill, Registration No. 5612S: The 1/4 sec. cor. of secs. 4 and 33, monumented with a stone, 12x7x4 ins., lying on top of the ground, in indentation, with "1/4" visible, face up, and witnessed by both original bearing trees. At the corner position, as determined by the found stone and bearing trees, set an aluminum pipe, 30 ins. long, 2 1/2 in. diam., 23 ins. in the ground, with the brass cap mkd. as shown:

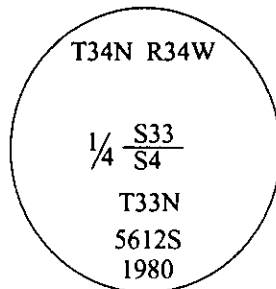

Established two new bearing trees:

A fir, 9 ins. diam., bears S32°W, 12.1 ft. dist., mkd. "1/4 S4 BT".

A fir, 8 ins. diam., bears N49°W, 15.1 ft. dist., mkd. "1/4 S33 BT".

Bury the original stone alongside and raise a collar of stone around the pipe.

II. Found a 2 1/2 in. diam. aluminum pipe, with a 3 1/4 in. diam. aluminum cap, firmly set, mkd. as shown above.

from which:

A fir, 18 ins. diam., bears S52°E, 26.2 ft. dist., with a healed face. (GLO-record-S58°E-27.0 ft.)

A fir, 9 ins. diam., bears S31°W, 12.3 ft. dist., with a healed face. (1980-record-S32°W)

A fir snag, 9 ins. diam., bears N49°W, 15.1 ft. dist., with a healed face. (1980-record)

III. Established one new bearing tree:

A fir, 14 ins. diam., bears S79°W, 32.1 ft. dist., mkd. "1/4 S4 BT".

Painted bearing trees and attached Land Survey Monument and Bearing Tree signs.

Magnetic Declination: 20° East.

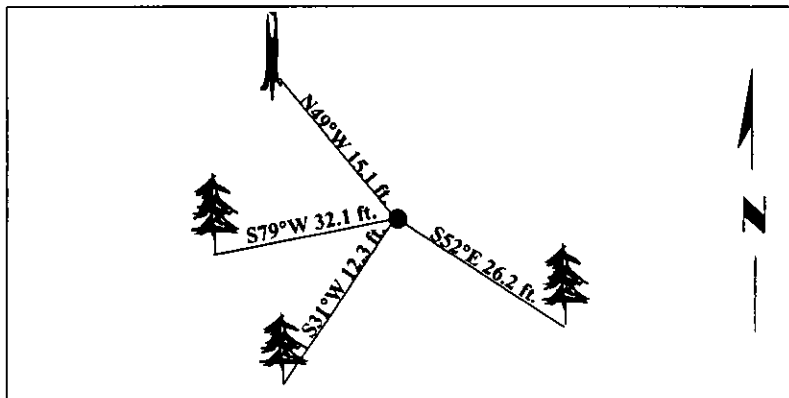

SKETCH OF CORNER

I. Thomas Hommel

certify the information shown herein is true and correct.

I. Ronald A. Pearson

certify that this Corner Record correctly represents work performed by me or under my direction in compliance with the "Corner Recordation Act" (70-22-101, et seq., M.C.A.)

Signature of Surveyor & Seal

Date: 06/10/97

Reg. No.: 9008LS

Employer: U.S. FOREST SERVICE

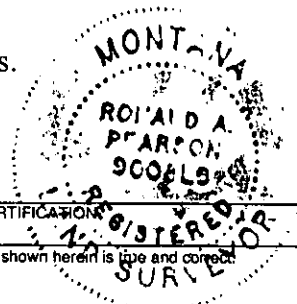

Office of Clerk and Recorder, County of LINCOLN. This "corner record" was filed for record on JULY 31, 1997 was noted on the cross-index plat and is assigned page No. 9858 in book No. CORAL M. CUMMINGS By RLB

County Official

Sec. 4

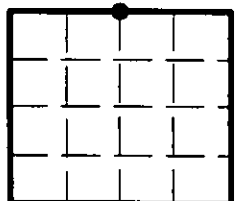

• - corner this sheet

Cross Index No. A-11 T. 33&34N R. 34W P.M., MT