

# CERTIFIED CORNER RECORDATION

Corner S 1/16 Sec. 9 & 10 T. 33 N R. 34 W P.M., MT Lincoln County

- I. 1979 Certified Corner Recordation by M. L. Haiges No. 2520S: Set a 2 in. diam. iron pipe, with a 2 1/2 in. diam. brass cap mkd. as shown:

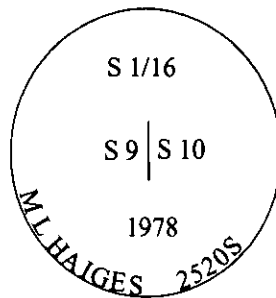

Established two bearing trees:

- A fir, 10 ins. diam., bears S78°E, 26.0 ft. dist. mkd. "S1/16 S10 RM".
- A fir, 6 ins. diam., bears N20°W, 72.9 ft. dist. mkd. "S1/16 S9 RM".

- II. Found and accepted, a 2 in. diam. iron pipe, protruding 6 ins. above the ground, firmly set, with a 2 1/2 in. diam. brass cap mkd. as shown above.

from which:

- A fir, 10 ins. diam., bears S78°E, 26.0 ft. dist. mkd. "S1/16 S10 RM".
- A fir, 10 ins. diam., bears N20°W, 72.9 ft. dist. mkd. with a healed face.
- A carsonite post, S.E., 1.0 ft., with location poster attached.

- III. Painted bearing trees and attached Land Survey Monument and Bearing Tree signs.



Magnetic Declination: 20° East.

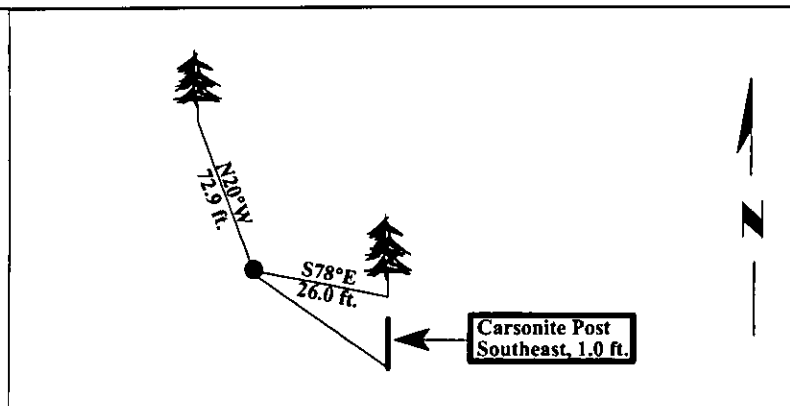

SKETCH OF CORNER

## CERTIFICATION

I, THOMAS M. HOMMEL  
certify the information shown herein is true and correct.

I, RONALD A. PEARSON  
certify that this Corner Record correctly represents work performed by me or under my direction in compliance with the "Corner Recordation Act" (70-22-101, et seq., M.C.A.)

Signature of Surveyor & Seal

Date: 12/30/96

Reg. No.: 9008LS

Employer: U.S. FOREST SERVICE

Office of Clerk and Recorder, County of LINCOLN. This "corner record" was filed for record on FEB 3, 1997 was noted on the cross-index plat and is assigned page No. 9071, in book No. \_\_\_\_\_

CORAL M. CUMMINGS

County Official

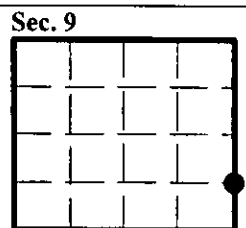

● - corner this sheet