

# CERTIFIED CORNER RECORDATION

Corner C-E-W Sec. 9 T. 33 N R. 34 W P.M., MT Lincoln County  
1/64

- I. No previous history.
- II. No evidence found.
- III. At the corner position, as determined by survey, set a 30 in. long, 3/4 in. diam. aluminum rod, 28 ins. in the ground, with a 3 1/4 in. diam. aluminum cap mkd. as shown:

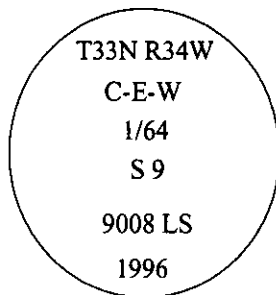

from which:

A larch, 16 ins. diam., bears N78°E, 25.8 ft. dist., mkd. "C-E-W 1/64 S9 BT".  
A pine, 8 ins. diam., bears S30°E, 20.0 ft. dist., mkd. "X BT".

Set a 6 ft. steel guard post, North, 5.0 ft., with Land Survey Monument and Property Boundary decals.

Painted bearing trees and attached Land Survey Monument and Bearing Tree signs.

Magnetic Declination: 20° East.

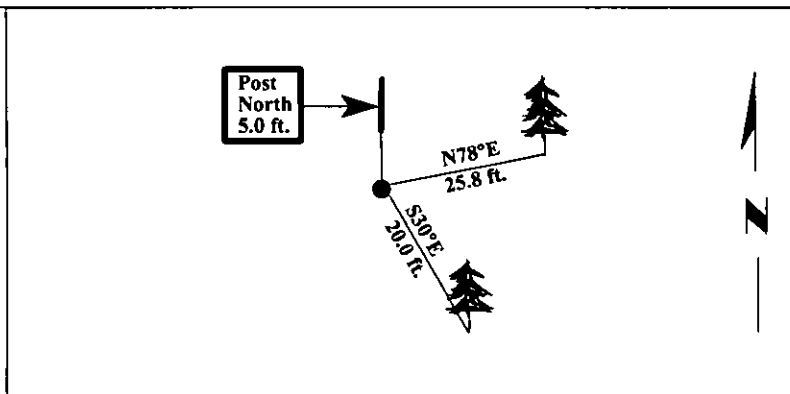
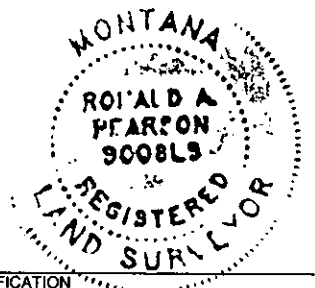

SKETCH OF CORNER

CERTIFICATION  
I, THOMAS M. HOMMEL  
certify the information shown herein is true and correct.  
*Thomas M. Hommel*  
I, RONALD A. PEARSON  
certify that this Corner Record correctly represents work performed by me or under my direction in compliance with the "Corner Recordation Act" (70-22-101, et seq., M.C.A.)  
*Ronald A. Pearson*  
Signature of Surveyor & Seal  
Date: 12/30/96  
Reg. No.: 9008LS  
Employer: U.S. FOREST SERVICE

Office of Clerk and Recorder, County of LINCOLN. This "corner record" was filed for record on FEB 3, 1997 and was noted on the cross-index plat and is assigned page No. 9070, in book No. \_\_\_\_\_.

CORAL M. CUMMINGS  
County Official

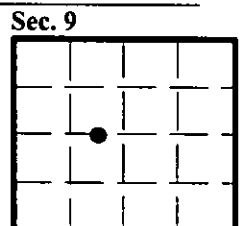

● - corner this sheet