

CERTIFIED CORNER RECORDATION

Corner CN 1/16 Sec. 9 T. 33 N R. 34 W P.M., MT Lincoln County

- I. 1993 Certificate of Survey No. 5017 By K.E.D. No. 4975S: Set a 1/2 in. rebar, with a yellow plastic cap mkd. "KED 4975S".
- II. Found a 1/2 in. rebar, with a yellow plastic cap mkd. "KED 4975S".
- III. At the corner position, as determined by the found rebar, set a 30 in. long, 2 1/2 in. diam. aluminum pipe, 27 ins. in the ground, with a 3 1/4 in. aluminum cap mkd. as shown:

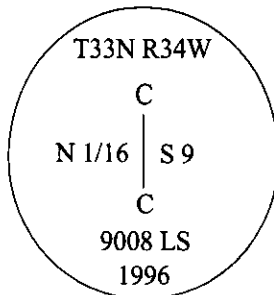

from which:

- A fir, 10 ins. diam., bears S50°E, 11.8 ft. dist., mkd. "CN 1/16 S9 BT".
- A fir, 9 ins. diam., bears S76°W, 19.9 ft. dist., mkd. "CN 1/16 S9 BT".

Placed the found rebar inside the aluminum pipe.

Set a steel guard post, North, 4.0 ft., with Land Survey Monument and Property Boundary decals.

Painted bearing trees and attached Land Survey Monument and Bearing Tree signs.

Magnetic Declination: 20° East.

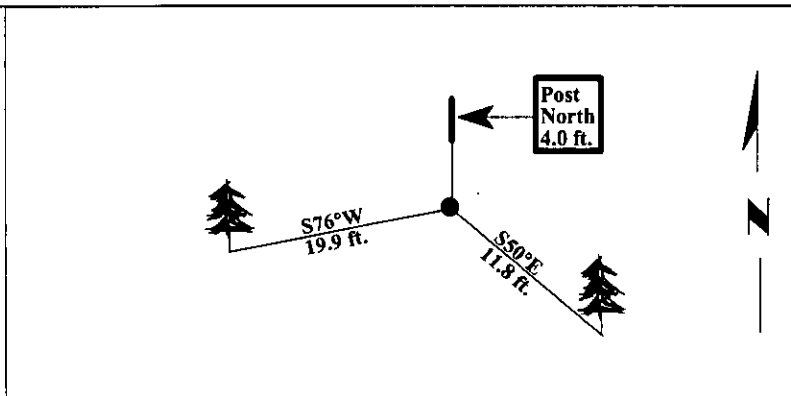
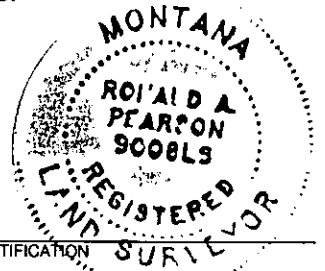

CERTIFICATION

I, THOMAS M. HOMMEL
certify the information shown herein is true and correct.

I, RONALD A. PEARSON
certify that this Corner Record correctly represents work performed by me or under my direction in compliance with the "Corner Recordation Act" (70-22-101, et seq., M.C.A.)

 Signature of Surveyor & Seal

Date: 12/30/96

Reg. No.: 9008LS

Employer: U.S. FOREST SERVICE

SKETCH OF CORNER

Office of Clerk and Recorder, County of LINCOLN. This "corner record" was filed for record on FEB 3, 1997 was noted on the cross-index plat and is assigned page No. 9065, in book No. _____

ORAL M. CUMMINGS
 County Official

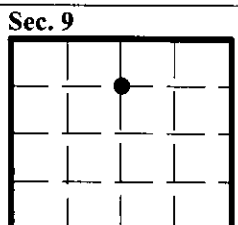

● - corner this sheet