

CERTIFIED LAND CORNER RECORDATION

DESCRIPTION OF CORNER EVIDENCE FOUND, AND ORIGINAL RECORD (IF KNOWN)

ORIGINAL G.L.O. NOTES: "Set a post, 3 ft. long, 4 ins. square, 24 ins. in the ground, for cor. of secs. 13, 14, 23 and 24, marked T 33 N S 13 on NE., R. 34 W S 24 on SE., S 23 on SW., and S 14 on NW. faces; with 3 notches on S. and 1 notch on E. edges, from which
 A tamarack, 22 ins. diam., bears N. 67°10' E., 66 lks. dist., marked T 33 N R 34 W S 13 B T.
 A tamarack, 6 ins. diam., bears S. 15°30' E., 27 lks. dist., marked T 33 N R 34 W S 24 B T.
 A tamarack, 5 ins. diam., bears S. 57° 45' W., 28 lks. dist., marked T 33 N R 34 W S 23 B T.
 A tamarack, 4 ins. diam., bears N. 30° W., 20 lks. dist., marked T 33 N R 34 W S 14 B T."
 FOUND: FOUND BRASS CAP MONUMENT SET BY THE B.L.M.

DESCRIPTION OF MONUMENT AND ACCESSORIES ESTABLISHED TO PERPETUATE THE ORIGINAL LOCATION OF THIS CORNER:

ORIGINAL EVIDENCE FOUND

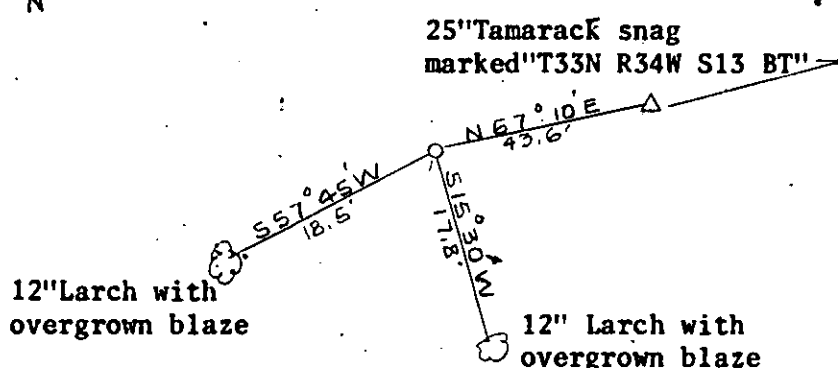

NEW EVIDENCE FOUND Date of work: OCT. 1979

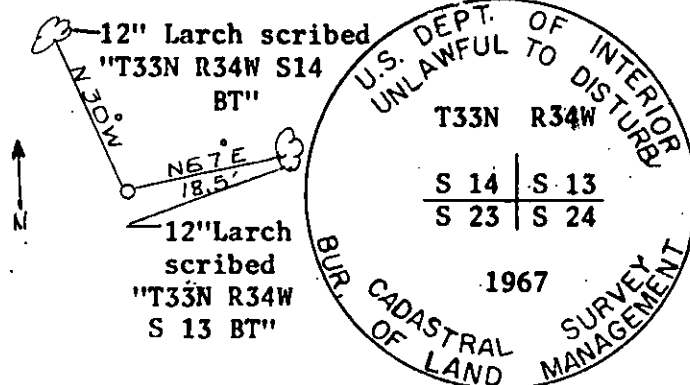

SKETCH, WITH COURSE AND DISTANCE TO ADJACENT CORNERS IF DETERMINED IN THIS SURVEY.
 (MAY SKETCH OR PASTE REPRODUCTION ON REVERSE SIDE.)

SEE BACK

Surveyor's Seal

I, JAMES BURTON
 certify that the information shown herein is true and correct.

James Burton
 Signature of Ground Party Chief

I, M. L. HAIGES
 certify that I have carefully performed or reviewed the work done on the diagrammed corner as reported on this recordation form and approve the same.

M. L. Haiges
 Signature of Surveyor

2520 S
 Registration Number

DIAGRAM OF CORNER:

T33N R34W

N.

14	13
23	24

= Corner recorded on the sheet

Office of Clerk and Recorder, County of LincolnThis "corner record" was filed for record on the 17th day of July, 1980, was noted on the cross-index plat and isassigned page No. 850, in book No. _____

Benjamin L. Vaughn, by Betty L. Loe
 County Official

SECTION 23 BREAKDOWN

SCALE 1"=1000'

