

CERTIFIED LAND CORNER RECORDATION

DESCRIPTION OF CORNER EVIDENCE FOUND, AND ORIGINAL RECORD (IF KNOWN)

ORIGINAL G.L.O. NOTES: "To angle and closing point, identical with listing corner No. 2, marked and witnessed as described by the District Forester. I destroy the listing corner and its accessories, and in its place establish for Cor. No. 2 and closing corner of this survey, as follows:

Place a small stone marked with a cross (x) under a limestone 26 x 12 x 6 ins., 16 ins. in the ground, marked C C on the NW., S.11 on the N., S.14 on the S., and 2 HES 1238 on the NE. faces, and with a cross (x) on top for the exact corner point, from which

A cross (x) on a tamarack tree 20 ins. dia. bears N.12°55'W., 56 lks. dist.,

A cross (x) on a tamarack tree 24 ins. dia. Bears S.29°55'W., 95 lks. dist., each bla ed and scribed 2 H E S 1238 C C B T."

FOUND:

FOUND BOTH BEARING TREES AND ORIGINAL STONE IN PLACE

DESCRIPTION OF MONUMENT AND ACCESSORIES ESTABLISHED TO PERPETUATE THE ORIGINAL LOCATION OF THIS CORNER:

Date of work: APRIL 1980

ORIGINAL EVIDENCE FOUND

NEW EVIDENCE SET

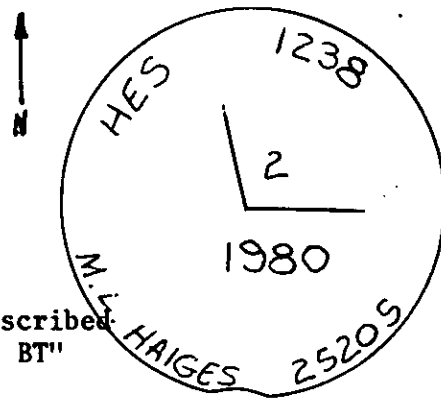
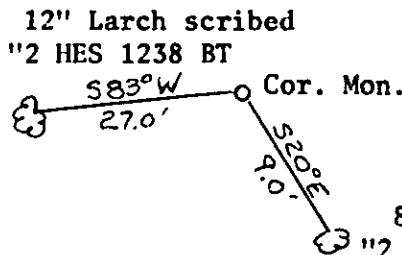
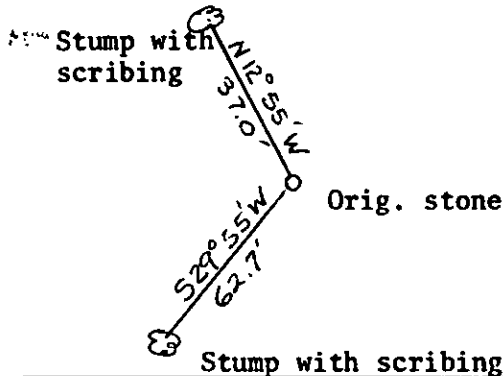

SKETCH, WITH COURSE AND DISTANCE TO ADJACENT CORNERS IF DETERMINED IN THIS SURVEY. (MAY SKETCH OR PASTE REPRODUCTION ON REVERSE SIDE.)

SEE BACK

Surveyor's Seal

I, JAMES BURTON
certify that the information shown herein is true and correct.

James Burton
Signature of Ground Party Chief

I, M. L. HAIGES
certify that I have carefully performed or reviewed the work done on the diagrammed corner as reported on this recordation form and approve the same.

M. L. Haiges
Signature of Surveyor

2520 S
Registration Number

DIAGRAM OF CORNER:

N. T33N R34W
CORNER 2
HES 1238

= Corner recorded on the sheet

Office of Clerk and Recorder, County of Lincoln

This "corner record" was filed for record on the 17th day of July, 1980, was noted on the cross-index plat and is assigned page No. 814, in book No. 19-30 T 33 R 34 Mer.

Edward L. Haiges, Jr.
County Official

Cross Index No. 19-30 T 33 R 34 Mer.

The following is a breakdown of the H.E.S. 1238 survey. The survey is a closed traverse with 17 points. The bearings and distances for each leg are as follows:
 1-2: N 89° 49' 16" W 858.68'
 2-3: N 20° 45' 54" W 773.35'
 3-4: N 44° 30' 25" W 1432.73'
 4-5: N 13° 13' 56" W 729.47'
 5-6: N 00° 10' 20" E 856.88'
 6-7: S 89° 46' 38" E 2644.69'
 7-8: S 89° 49' 02" E 664.78'
 8-9: S 00° 05' 39" W 331.30'
 9-10: S 89° 45' 40" E 330.88'
 10-11: N 00° 02' 08" W 1000.45'
 11-12: S 89° 49' 43" E 464.60'
 12-13: S 00° 16' 30" W 2658.46'
 13-14: S 00° 14' 29" E 1322.49'
 14-15: N 00° 01' 20" E 1326.61'
 15-16: S 00° 12' 14" E 2661.50'
 16-17: S 00° 16' 30" W 2658.46'
 17-1: S 89° 49' 43" E 464.60'

SECTION II BREAKDOWN AND H.E.S. 1238

