

- INSTRUCTIONS
1. Original and duplicate record used to evaluate the corner position.
  2. Description of monument and accessories set to perpetuate the corner position.
  3. Description of monument and accessories set to perpetuate the corner position.
  4. Sketch of corner, show all pertinent data which can best be shown in a sketch example, corner marking, topography files, position of accessories, etc.
  5. Certification must be signed and sealed by Land Surveyor registered in the State of Montana.
  6. Fill in Cross Index & Section Diagram at bottom of sheet.

## CERTIFIED CORNER RECORDATION

Corner C 1/4 Section 17 T. 33 N R. 34 W P.M.M. Lincoln County

### RECORD:

No other corner of record was set.

### FOUND:

No monuments were found during field search.

### MAINTENANCE:

The C 1/4 of Sec. 17, T. 33 N., R. 34 W., was set by computed location from a sec. breakdown of Sec. 17, T. 33 N., R. 34 W., P.M.M., by Davis Surveying on record in the Lincoln County Courthouse.

At the calculated position, set a Railroad spike approx. 15 ft. NE of Hwy. 2 centerline, with a divot on top for exact position.

We established two (2) Bearing Trees described as follows:

A 8 inch diam. Cedar bears N. 12° E. 44.8 ft. dist. scribed (C 1/4 S. 17 BT).

A 5 inch diam. Douglas Fir bears S. 79° E. 55.0 ft. dist. scribed (C 1/4 S. 17 BT).

Painted scribes red and 6 inch red bands around both Bearing Trees.

Attached Bearing Tree signs to both trees.

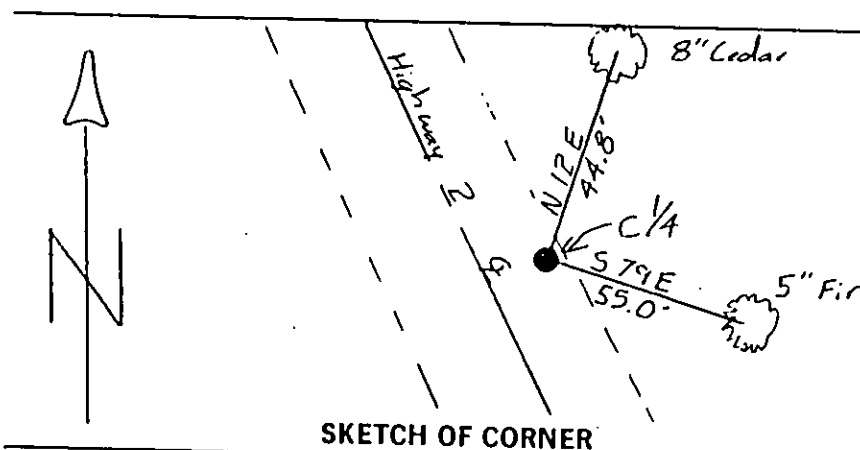

### CERTIFICATION

I, Glenn M. Knodle

certify the information shown herein is true and correct.

Glenn M. Knodle  
Signature Ground Party Chief

I, Ken E. Davis

certify that this Corner Record correctly represents work performed by me or under my direction in compliance with the "Corner Recordation Act" (70-22-101, et seq., M.C.A.)

Ken E. Davis  
Signature of Surveyor & Seal

Date: 7/15/93 Reg. No. 4975-S

Employer: Davis Surveying, Inc.

Office of Clerk and Recorder, County of Lincoln. This "corner record" was filed for record on 12-16-93 was noted on the cross-index plat and is assigned page No. 6007, in book No.                     

L-07  
Cross Index No. C 1/4 T. 33N R. 34W P.M.M.

Sec. 17

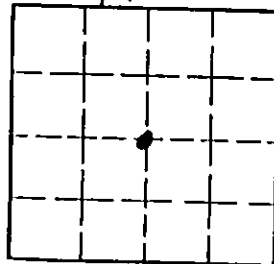

• - corner this sheet