

- INSTRUCTIONS
1. Original monument record used to evaluate the corner position.
 2. Description of monument found, note discrepancies in the record, state method of finding lost or obliterated corners.
 3. Description of monument and accessories set to perpetuate the corner position.
 4. Sketch of corner, show all pertinent data which can best be shown in a sketch example, corner marking, topography ties, position of accessories, etc.
 5. Certification must be signed and sealed by Land Surveyor registered in the State of Montana.
 6. Fill in Cross Index & Section Diagram at bottom of sheet.

CERTIFIED CORNER RECORDATION

Corner CW 1/16 Section 17 T. 33 N R. 34 W P.M.M. Lincoln County

RECORD:

No other corner of record was set.

FOUND:

A 5/8 inch diam. x 24 inch long rebar with a 1 1/4 inch diam. plastic cap stamped: JHN 4661S 21 ins. in the ground with two (2) Bearing Trees.

MAINTENANCE:

The CW 1/16 of Sec. 17, T. 33 N., R. 34 W., was set by computed location from a sec. breakdown of Sec. 17, T. 33 N., R. 34 W., P.M.M., by Davis Surveying on record in the Lincoln County Courthouse.

At the calculated position, set a 5/8 inch diam. x 24 inch long rebar with a 1 1/4 inch diam. plastic cap stamped: KED 4975S 21 ins. in the ground.

A 5/8 inch diam. x 24 inch long rebar with a 1 1/4 inch diam. cap stamped: JHN 4461S bears S. 05°08'24" W. 12.30 ft. dist.

We established one (1) new and two (2) existing Bearing Trees described as follows:

A new 12 inch diam. fir bears N. 49° E. 47.4 ft. dist. scribed (CW 1/16 S. 17 BT).

An old 16 inch diam. Cedar bears S. 13 1/2° E. 21.0 ft. dist. scribed (W 1/16 S. 17 BT).

An old dead 8 inch diam. Fir bears S. 14° W. 26.1 ft. dist. scribed (W 1/16 S. 17 BT).

Painted new Bearing Tree scribes red and 6 inch red band around Bearing Tree.

Attached Bearing Tree sign to new Bearing Tree.

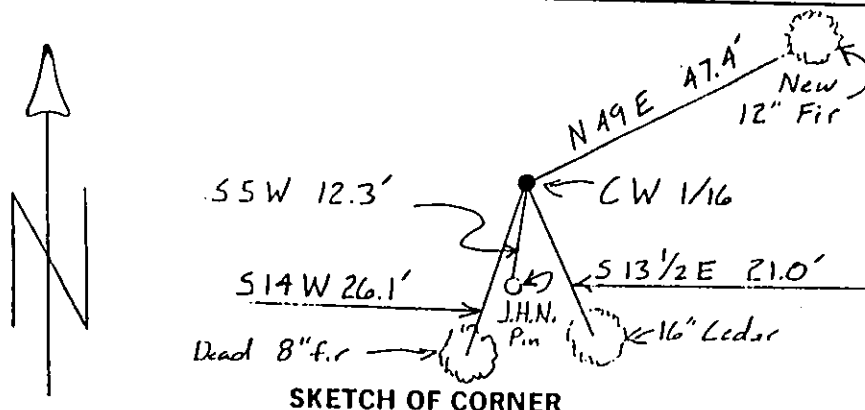

SKETCH OF CORNER

CERTIFICATION	
I, <u>Glenn M. Knodle</u>	
certify the information shown herein is true and correct.	
<u>Glenn M. Knodle</u>	Signature Ground Party Chief
I, <u>Ken E. Davis</u>	
certify that this Corner Record correctly represents work performed by me or under my direction in compliance with the "Corner Recordation Act" (70-21-10, et seq., M.C.A.)	
<u>Ken E. Davis</u>	Signature of Surveyor & Seal
Date: <u>12/15</u>	Reg. No. <u>4975-S</u>
Employer: <u>Davis Surveying, Inc.</u>	

Office of Clerk and Recorder, County of Lincoln. This "corner record" was filed for record on 12-16-95 was noted on the cross-index plat and is assigned page No. 6006, in book No.

Ken E. Davis
County Official
L-06
Cross Index No. CW 1/16 T. 33N R. 34W P.M.M.

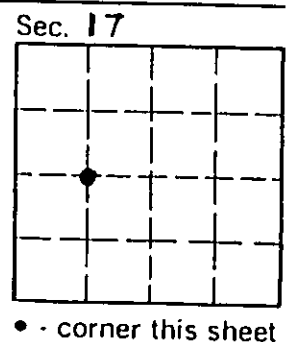

• corner this sheet