

INSTRUCTIONS

1. Original and/or subsequent record used to evaluate the corner position.
2. Description of evidence found, note discrepancies in the record, state method of establishing lost or obliterated corners.
3. Description of monument and accessories set to perpetuate the corner position.
4. Sketch of corner, show all pertinent data which can best be shown in a sketch example, corner marking, topography ties, position of accessories, etc.
5. Certification must be signed and sealed by Land Surveyor registered in the State of Montana.
6. Fill in Cross Index & Section Diagram at bottom of sheet.

CERTIFIED CORNER RECORDATION

Corner 17 of ES 1258 & CW 1/16 Sec. 21 T. 33 N. R. 34 W. P.M.M. Lincoln County

- I. 1941 U.S.D.A. F.S. Exchange Survey No. 1258 by Donald Sawhill: "Set an iron post, 3 ft. long, 2 in. diam., 26 ins. in the ground, with broken glass deposited at the base, with brass cap marked

17 E S
1258 CW 1/16
S21
1941

The point on the brass cap is the exact cor. point from which

A cross (x) on white fir, 8 ins. diam., bears N57°30'W, 45 lks. dist.

A cross (x) on a douglas fir, 10 ins. diam., bears N41°45'E, 35 lks. dist., each blazed and scribed 1/16 S 17 E S 1258 B T."

1989 Corner Recordation by Carl R. McMillen:

"FOUND: Found the brass cap and iron pipe flush with the ground marked as shown below.
No evidence of original BT's found.

MAINTENANCE: Established 2 new bearing trees:

A 7 1/2" cedar bears N69°W, 18.9 feet, marked CW 1/16 S21 BT.

A 6" hemlock, bears N18°W, 65.8 feet, marked CW 1/16 S21 BT.

- II. Found a 2 in. diam. iron pipe, 4 ins. above ground with 2 1/2 ins. diam. U.S.F.S. brass cap, marked as shown:

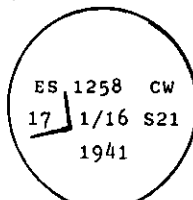

from which

Rotten remains of a fir, bears N53°W, 29.7 ft. (45 lks.) dist., mkd. 17 ES 1258.

A cedar, 11 ins. diam., bears N74°W, 18.8 feet, marked CW 1/16 S21 BT.

A hemlock, 6 ins. diam., bears N18°W, 65.8 feet, visible scribe marks.

- III. Painted red bands around the bearing trees and attached Land Survey Monument and Bearing Tree signs.

Set a 6 ft. galvanized steel guard post with Land Survey Marker and Property Boundary decals, West, 5 ft.

Magnetic Declination: 20° East

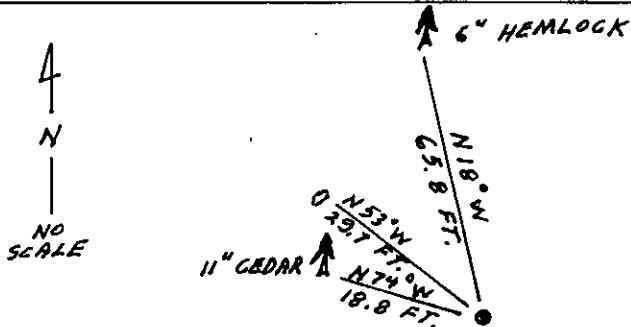

SKETCH OF CORNER

CERTIFICATION

I, Thomas M. Hommel
certify the information shown herein is true and correct.
Thomas M. Hommel
Signature Ground Party Chief

I, Alvah F. Hughes
certify that this Corner Record correctly represents work performed by me or under my direction in compliance with the "Corner Recordation Act" (70-22-101, et seq., M.C.A.)

Alvah F. Hughes
Signature of Surveyor & Seal

Date: 12/18/92 Reg. No. 732316

Employer: U.S. FOREST SERVICE

Office of Clerk and Recorder, County of Lincoln. This "corner record" was filed for record on Jan 19, 1993 was noted on the cross-index plat and is assigned page No. 5305, in book No. Coral M. Cumming By DB

County Official

Cross Index No. 17 ES 1258 T. 33 N R. 34 W PMM

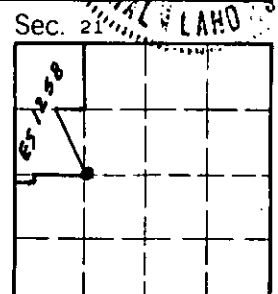

• - corner this sheet