

## INSTRUCTIONS

1. Original and/or subsequent record used to evaluate the corner position.
2. Description of evidence found, note discrepancies in the record, state method of establishing lost or obliterated corners.
3. Description of monument and accessories set to perpetuate the corner position.
4. Sketch of corner, show all pertinent data which can best be shown in a sketch example, corner marking, topography ties, position of accessories, etc.
5. Certification must be signed and sealed by Land Surveyor registered in the State of Montana.
6. Fill in Cross Index & Section Diagram at bottom of sheet.

## CERTIFIED CORNER RECORDATION

Corner 16 of ES 1258 T. 33 N. R. 34 W. P.M.M. Lincoln County

- I. 1941 U.S.D.A. P.S. Exchange Survey No. 1258 by Donald Sawhill: "Set an iron post, 3 ft. long, 2 ins. diam., 26 ins. in the ground, with broken glass deposited at the base, with brass cap marked

16 E S 1258  
1941

The point on the brass cap is the exact cor. point from which

A cross (x) on cedar, 6 ins. diam., bears  $N32^{\circ}25'W$ , 25 lks. dist.

A cross (x) on a cedar, 6 ins. diam., bears  $N62^{\circ}05'E$ , 30 lks. dist., each blazed and scribed 16 E S 1258 B T.

Raise a mound of earth 4 ft. base, 2 ft. high, W. of corner.

- II. Found a 2 in. diam. iron pipe, bent over with 2 1/2 ins. diam. U.S..P.S. brass cap, marked as shown:

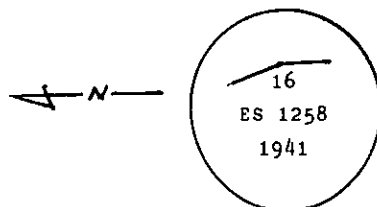

from which:

A cedar, 26 ins. diam., bears  $N32^{\circ}W$ , 16.5 ft. (25 lks.) dist., overgrown scribe.

A cedar stump, 18 ins. diam., bears  $N62^{\circ}E$ , 19.8 ft. (30 lks.) dist., overgrown scribe.

- III. Re-set the iron pipe by distance-distance intersection from original Bearing Trees.

Establish one new Bearing Tree:

A larch, 8 ins. diam., bears  $S69^{\circ}W$ , 17.2 ft. dist., mkd. 16 ES 1258 BT.

Painted red bands around the bearing trees and attached Land Survey Monument and Bearing Tree signs.

Set a 6 ft. galvanized steel guard post with Land Survey Marker and Property Boundary decals, North, 3 ft.

Magnetic Declination:  $20^{\circ}$  East

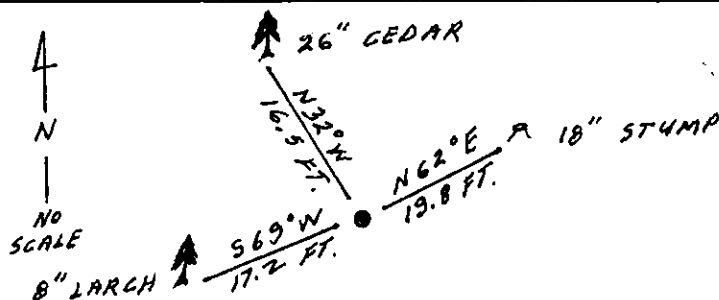

## SKETCH OF CORNER

## CERTIFICATION

I, Thomas M. Hommel  
certify the information shown herein is true and correct.  
*Thomas M. Hommel*  
Signature Ground Party Chief

I, Alvah F. Hughes  
certify that this Corner Record correctly represents work performed by me or under my direction in compliance with the "Corner Recordation Act" (70-22-101, et seq., M.C.A.).  
*Alvah F. Hughes*  
Signature of Surveyor & Seal  
Date: 12/18/92 Reg. No. 7322ES  
Employer: U.S. FOREST SERVICE

Office of Clerk and Recorder, County of Lincoln. This "corner record" was filed for record on Jan 19, 1993 was noted on the cross-index plat and is assigned page No. 5304, in book No. Coral M. Cummings, DB  
County Official

Cross Index No. 16 ES 1258 T. 33 N R. 34 W PMM

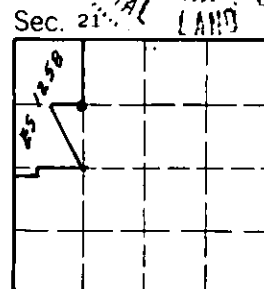

• - corner this sheet