

1. Original and subsequent record used to evaluate the corner position.
2. Description of monument found, note discrepancies in the record, state method of adjustment.
3. Description of monument and accessories used to perpetuate the corner position.
4. Sketch or survey, show all pertinent data which can best be shown in a sketch, e.g., corner marking, topography, ties, position of accessories, etc.
5. Certification must be signed and sealed by Registered Land Surveyor in State of Montana.
6. Fill in Cross Index & Section Diagram at bottom of sheet.

## CERTIFIED CORNER RECORDATION

Corner W 1/16 S21/28 T. 33N R. 31W P.M.M. Lincoln County

**RECORD:** The original G.L.O. survey was conducted by Allen B. Benedict in 1905. The monument was originally set as part of HES survey No. 898 as conducted by Grant Higgins in 1922.... "placed a small stone marked with a cross under a slate stone 24" x 10" x 9", 14 inches in the ground, marked 1/16 S on the north face and 11 HES 898 on the southeast face and a cross on top for the exact corner point, from which:

A cross on a 14" fir bears N 29 30' W, 36 links (23.76 feet), marked "1/16S 11 HES 898 BT."

A cross on a 6" fir bears N 19 30' E, 62 links (40.92 feet), marked "1/16S 11 HES 898 BT."

**FOUND:** An 11"x10"x4" slate stone upright and firmly in the ground with "11 HES 898" on the south side of the stone (the north side of the stone appears to have split off). A mound of stone lies southeast of the corner. No evidence of original B.T.'s found.

**MAINTENANCE:** Established 2 new bearing trees.

A 9" douglas fir bears N67 E, 14.40 feet, marked "W1/16 S21 BT"

A 6" douglas fir bears S83 W, 23.90 feet, marked "W1/16 S28 BT"

The balzes were painted red and a 6" red band was painted around each tree. Bearing tree tags were attached to the front of each tree and Land Monument signs were attached to the back.

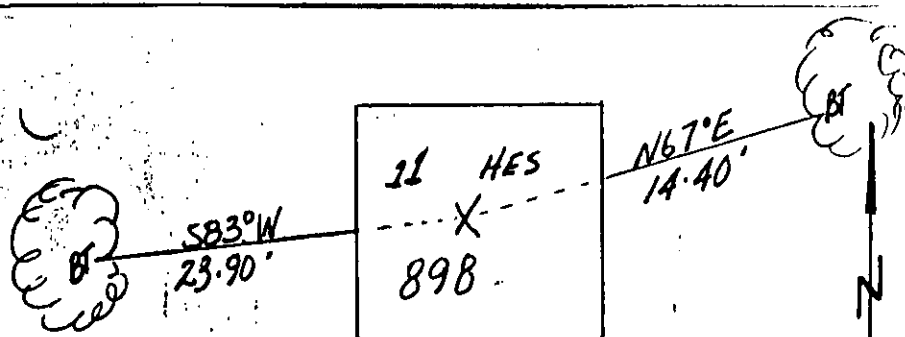

SKETCH OF CORNER

CERTIFICATION

I, Steven R. Moyer, certify the information shown herein is true and correct.

Signature of County Party Clerk

I, Carl R. McMillen, certify that this Corner Record was properly performed by me or under my direction in accordance with the Surveyor's Recordation Act (MCA 19-1-101 et seq.)

Signature of Surveyor & Seal

Date: 4-10-89 Reg. No. 4659S

Employer: Tri-State Land Surveying

Office of Clerk and Recorder, County of Lincoln. This "corner record" was filed for record on the April 24 day of 1989 was noted on the cross-index plat and is assigned page No. 4055, in book No. \_\_\_\_\_

Janet BT Sargent by Bill Buckhoff  
County Official

Sec. 21

21