

INSTRUCTIONS

1. Original and/or subsequent record used to evaluate the corner position.
2. Description of evidence found, note discrepancies in the record, state method of establishing lost or obliterated corners.
3. Description of monument and accessories set to perpetuate the corner position.
4. Sketch of corner, show all pertinent data which can best be shown in a sketch example, corner marking, topography ties, position of accessories, etc.
5. Certification must be signed and sealed by Registered Land Surveyor in State of Montana.
6. Fill in Cross Index & Section Diagram at bottom of sheet.

CERTIFIED CORNER RECORDATION

Corner Section 2 ^{1/4} Section 1 T. 33 N. R. 34 W., P.M.M. Lincoln County

- 1) Original Record: Set a Sandstone, 21 x 12 x 3 ins. in the ground, for 1/4 sec. cor., marked 1/4 on W. face; and raise a mound of stone, 2 ft. base, 1-1/2 ft. high, W. of cor., Pits impracticable.
- 2) Evidence Found: Found Original Sandstone as described above, 5 x 12 x 3 ins. above ground, complete with original mound of stone. No BTs.
- 3) Accessories Set to Perpetuate Corner: From the cross {x} on top of the Original Sandstone:
 - a Douglas Fir, 10 ins. dia., bears N. 76°E., 20.7 ft. dist., blazed and scribed: 1/4 S1 BT, and painted red
 - a Douglas Fir, 8 ins. dia., bears S 62°30'W., 6.9 ft. dist., blazed and scribed: 1/4 S 2 BT, and painted red.

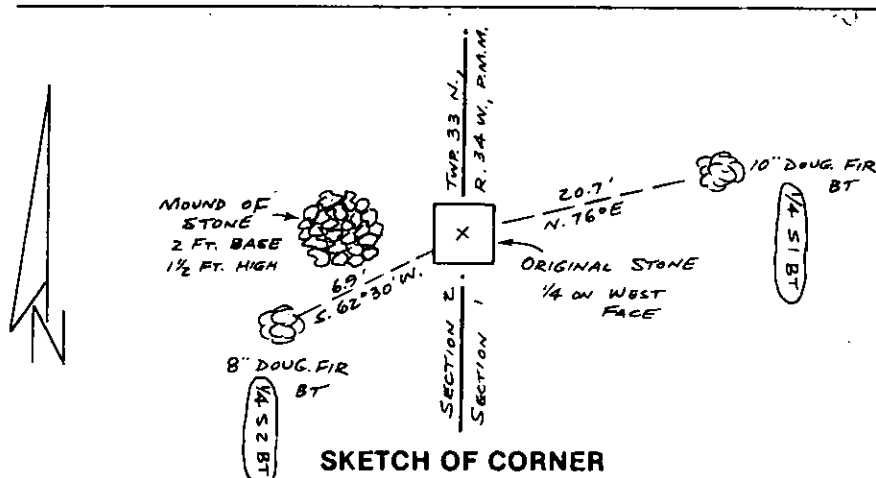

SKETCH OF CORNER

CERTIFICATION

John R. Damon

I, John R. Damon certify the information shown herein is true and correct.

Signature Ground Party Chief

I, Melvin D. Lauteren

certify that this Corner Record correctly represents work performed by me or under my direction in compliance with the "Corner Recordation Act" (70-22-101 M.C.A.)

Signature of Surveyor & Seal

Date: 10/18/84 Reg. No. 4232 SEmployer: Kootenai Engineering, Inc.

Office of Clerk and Recorder, County of LINCOLN. This "corner record" Sec. 2 T. 33 N., R. 34 W.
 was filed for record on the 15th day of NOV 19 84, was noted on the cross-index plat and
 is assigned page No. 2771, in book No. James B. Siegel by Betty

County Official

Conces
deputy

Cross Index No. _____ T. _____ R. _____ P.M.M.

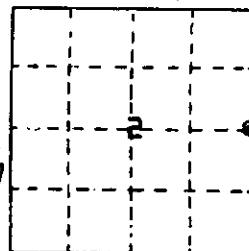

• corner this sheet