

# CERTIFIED CORNER RECORDATION

Corner NESWSW 1/256 S5 T 33 N. R. 34 W. P.M.M. Lincoln County

I. Record: None

II. Found: No record monuments found.

III. Perpetuation: At the corner point, determined by survey, set a 5/8 ins. diam. steel rebar 24 ins. long, 23 ins. in the ground, with a 3 1/4 ins. diam. U.S.F.S Aluminum cap marked as shown below from which:

A Fir, 8 ins. diam., bears S4° E, 11.70 ft. dist., scribed 1/256 S5 BT.

A Fir, 12 ins. diam., bears N44°W, 12.10 ft. dist., scribed 1/256 S5 BT.

Painted faces and 6 in. wide red bands to all bearing trees and attached Land Survey Monument and Bearing Tree signs.

Set steel posts on line 2.5 ft. North and East of set monument with attached Survey Monument and Property Line stickers.

Magnetic declination: 18° East

Equipment used: Hand compass and loggers tape

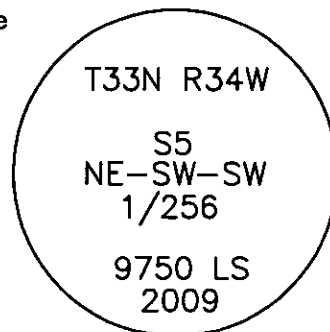

Kootenai Surveyors Inc., 314 California Av., Libby, MT. 59923 (406) 293-4354

Pine Creek 2009

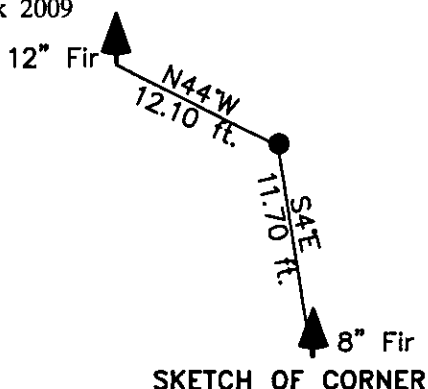

SKETCH OF CORNER

## CERTIFICATION

Kelly Rooney

I certify the information shown herein is true and correct.

*Kelly Rooney*  
Signature Ground Party Chief

Steven Boyer

I certify that this Corner Record correctly represents work performed by me or under my direction in compliance with the "Corner Recordation Act" (70-22-101, et seq., M.C.A.)

*Steven A. Boyer*  
Signature of Surveyor & Seal

Date: 12/01/2009 Reg. No. 9750-65750LS

Employer: Kootenai National Forest

Sec. 05

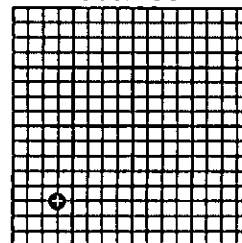

• corner this sheet

Office of Clerk and Recorder, County of Lincoln This "corner

record" was filed for record on 224332 BOOK: CCR CC&R'S PAGE: 11441 Pages: 1

was noted on the cr STATE OF MONTANA LINCOLN COUNTY

book No. RECORDED: 02/04/2010 2:08 KOI: CC&R'S

TAMMY D. LAUER CLERK AND RECORDER

FEE: \$0.00

BY: *Steven A. Boyer*

TO: STEVE BOYER-SURVEYOR US FOREST SERVICE,

Cross Index No. D.26-5.75 T. 33N R. 34W P.M., MT

Adopted July 1, 1981, Montana Board of Professional Engineers & Land Surveyors