

# CERTIFIED CORNER RECORDATION

Corner CNSN 1/256 S5 T. 33 N. R. 34 W. P.M.M. Lincoln County

I. Record: 1997 "Baker Acres", P.F. Plat No. 5938 Lincoln County Records, by Marquardt Surveying.

II. Found: A 5/8 diam. rebar with plastic cap stamped MARQUARDT 7329S, which bears N73°05'25"W, 4.61 ft. dist. from the corner point determined by survey. Not accepted this survey.

III. Perpetuation: At the corner point, determined by survey, set a 5/8 ins. diam. steel rebar 24 ins. long, 22 ins. in the ground, with a 3 1/4 ins. diam. U.S.F.S Aluminum cap marked as shown below from which:

A white pine, 24 ins. diam., bears S42° W, 21.75 ft. dist., scribed 1/256 S5 BT.

A cedar, 10 ins. diam., bears S79°W, 37.90 ft. dist., scribed 1/256 S5 BT.

Painted faces and 6 in. wide red bands to all bearing trees and attached Land Survey Monument and Bearing Tree signs.

Set steel posts on line 3 ft. East and South of set monument with attached Survey Monument and Property Line stickers.

Magnetic declination: 18° East

Equipment used: Hand compass and loggers tape

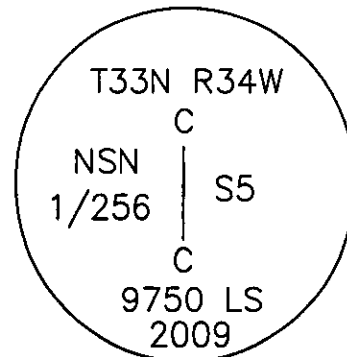

Kootenai Surveyors Inc., 314 California Av., Libby, MT. 59923 (406) 293-4354

Pine Creek 2009

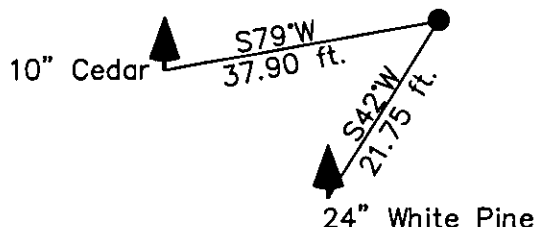

SKETCH OF CORNER

## CERTIFICATION

I, Kelly Rooney  
certify the information shown herein is true and correct.

*Kelly Rooney*  
Signature of Ground Party Chief

I, Steven Boyer  
certify that this Corner Record correctly represents work performed by me or under my direction in compliance with the "Corner Recordation Act" (70-22-101 et seq. M.C.A.)

*Steven Boyer*  
Signature of Surveyor & Seal

Date: 12/01/2009 Reg. No. 9750-LS

Employer: Kootenai National Forest

Office of Clerk and Recorder, County of Lincoln This "corner

record" was filed for record on 224328 BOOK: CCR CC&R'S PAGE: 11437 Pages: 1

was noted on the cross-in STATE OF MONTANA LINCOLN COUNTY  
book No. RECORDED: 02/04/2010 2:06 KOI: CC&R'S

TAMMY D. LAUER CLERK AND RECORDER

FEE: \$0.00

BY *Steven Boyer*

TO: STEVE BOYER-SURVEYOR US FOREST SERVICE,

Cross Index No. B. 25-7 T. 33N R. 34W P.M., MT

Adopted July 1, 1981, Montana Board of Professional Engineers & Land Surveyors

Sec. 05

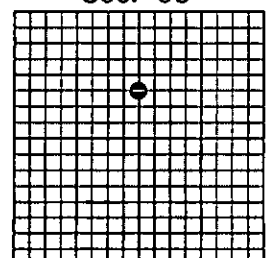

• corner this sheet