

CERTIFIED CORNER RECORDATION

Corner CWWW 1/256 S5 T. 33 N. R. 34 W. P.M.M. Lincoln County

I. Record: None

II. Found: No record monuments found.

III. Perpetuation: At the corner point, determined by survey, set a 3 1/4 ins. diam. U.S.F.S Aluminum rock cap in concrete marked as shown below from which:

A Pine, 10 ins. diam., bears N55° E, 17.80 ft. dist., scribed 1/256 S5 BT.

A Fir, 19 ins. diam., bears N74° E, 71.00 ft. dist., scribed 1/256 S5 BT.

Painted faces and 6 in. wide red bands to all bearing trees and attached Land Survey Monument and Bearing Tree signs.

Set steel posts on line 3.0 ft. East and North of set monument with attached Survey Monument and Property Line stickers.

Magnetic declination: 18° East

Equipment used: Hand compass and loggers tape

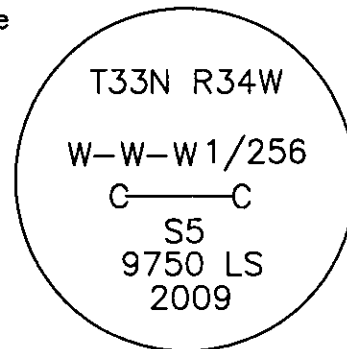

Kootenai Surveyors Inc., 314 California Av., Libby, MT. 59923 (406) 293-4354

Pine Creek 2009

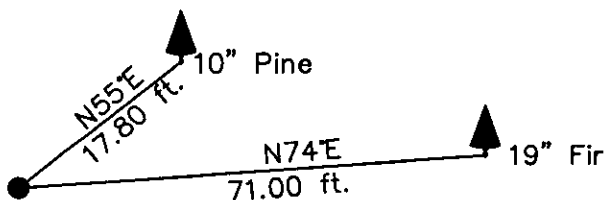

SKETCH OF CORNER

CERTIFICATION

I, Kelly Rooney
certify the information shown herein is true and correct.

Kelly Rooney
Signature Ground Party Chief

I, Steven Boyer
certify that this Corner Record correctly represents work performed by me or under my direction in compliance with the "Corner Recordation Act" (70-22-101, et seq., M.C.A.)

Steven Boyer
Signature of Surveyor & Seal

Date: 12/01/2009 Reg. No. 9356-MSN A.

Employer: Kootenai National Forest

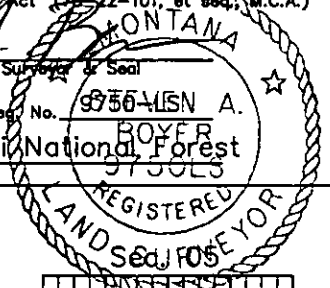

Office of Clerk and Recorder, County of Lincoln. This "corner

record" was filed for record on 224321 BOOK: CCR CC&R'S PAGE: 11430 Pages: 1

was noted on the cross: STATE OF MONTANA LINCOLN COUNTY
book No. RECORDED: 02/04/2010 2:00 KOI: CC&R'S

TAMMY D. LAUER CLERK AND RECORDER

FEE: \$0.00

BY: Steven Boyer

TO: STEVE BOYER-SURVEYOR US FOREST SERVICE,

Cross Index No. C5.25 T. 33N R. 34W P.M., MT

Adopted July 1, 1981, Montana Board of Professional Engineers & Land Surveyors

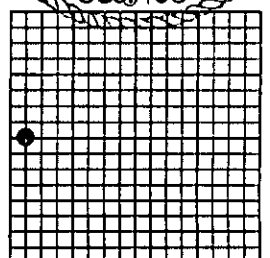

• corner this sheet