

INSTRUCTIONS

1. Original and/or subsequent record used to evaluate the corner position.
2. Description of evidence found, note discrepancies in the record, state method of establishing lost or obliterated corners.
3. Description of monument and accessories set to perpetuate the corner position.
4. Sketch of corner, show all pertinent data which can best be shown in a sketch example, corner marking, topography ties, position of accessories, etc.
5. Certification must be signed and sealed by Land Surveyor registered in the State of Montana.
6. Fill in Cross Index & Section Diagram at bottom of sheet.

CERTIFIED CORNER RECORDATION

Corner NE-SW 1/64 SEC. 16 T. 33N R. 34W P.M.M. Lincoln County

The new corner monument was established as a result of a subdivisioal survey of the Section. Said subdivisioal survey was made in accordance with methods and procedures contained in the Manual of Surveying Instructions (1973); U.S. Bureau of Land Management.

FOUND:

A 1 1/4" white plastic cap marked JHN 4661S on 5/8" rebar within positional tolerance.

ESTABLISHED:

Replaced plastic cap with a 3 1/4" aluminum cap on found rebar, marked as shown below; from which:

A 6" Lodge Pole Pine bears S28 1/2°E, 19.0 feet, scribed NE SW 1/64 S16 BT.

A 7" Lodge Pole Pine bears S76 1/4°E, 43.8 feet, scribed NE SW 1/64 S16 BT.

Set a 6' metal post, with land survey monument decal attached, 2.0 feet south and 2.0 feet east of monument.

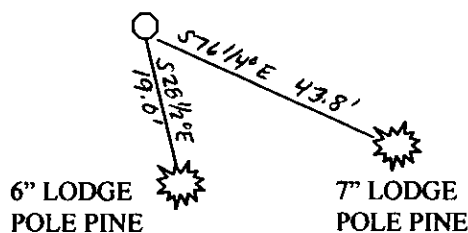
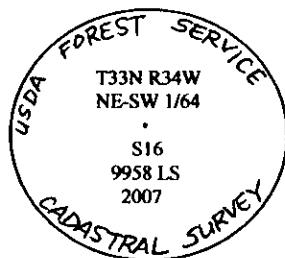

SKETCH OF CORNER

CERTIFICATION

I, James R. Staples
 Certify the information shown herein is true and correct.

James R. Staples
 Signature Ground Party Chief

I, James R. Staples
 certify that this Corner Record correctly represents work performed by me or under my direction in compliance with the "Corner Recordation Act" (70-22-101, et seq., M.C.A.)

James R. Staples
 Signature of Surveyor & Seal

Date: 7-17-07 Reg. No. 9958LS

Employer: J.R.S. Surveying, Inc.

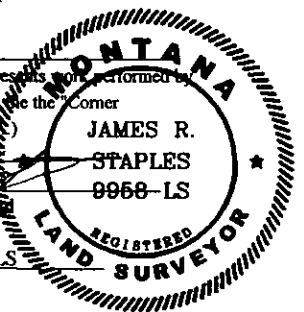

Office of Clerk a 204583 BOOK: CCR CC&R'S PAGE: 11075 Pages: 1

record" was filed STATE OF MONTANA LINCOLN COUNTY

RECORDED: 07/25/2007 10:40 KOI: CC&R'S

was noted on the TAMMY D. LAUER CLERK AND RECORDER

FEE: \$0.00

BY: Lee Blomdale, Deputy

book no. _____ TO: FILED

County Official

Cross Index No. LL13 T. 33N R. 34W PMM

Adopted July 1, 1981, Montana Board of Professional Engineers & Land Surveyors

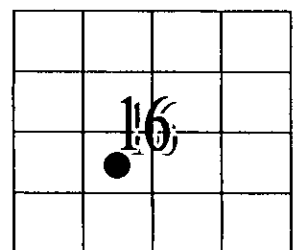

• - Corner this sheet