

INSTRUCTIONS

1. Original and/or subsequent record used to evaluate the corner position.
2. Description of evidence found, note discrepancies in the record, state method of establishing lost or obliterated corners.
3. Description of monument and accessories set to perpetuate the corner position.
4. Sketch of corner, show all pertinent data which can best be shown in a sketch example, corner marking, topography ties, position of accessories, etc.
5. Certification must be signed and sealed by Land Surveyor registered in the State of Montana.
6. Fill in Cross Index & Section Diagram at bottom of sheet.

CERTIFIED CORNER RECORDATION

Corner E 1/16 SEC. 16 T. 33N R. 34W P.M.M. Lincoln County

The new corner monument was established as a result of a subdivisinal survey of the Section. Said subdivisiional survey was made in accordance with methods and procedures contained in the Manual of Surveying Instructions (1973); U.S. Bureau of Land Management.

FOUND:

Found rebar and cap marked "JHN 4661S" (disturbed)

A 14" tamarack bears S28 $\frac{3}{4}$ °E, 38.4 feet, no visible scribing, healed scar and snow blaze, no tag found.

ESTABLISHED:

Set a 3 $\frac{1}{4}$ " aluminum cap on a 5/8" rebar, set flush with ground, marked as shown below; from which:

A 12" Hemlock bears N14 $\frac{3}{4}$ °E, 68.8 feet, scribed E1/16 S9 BT.

Set a 6' metal post, with land survey monument decal attached, 2.0 feet east and 2.0 feet south of monument.

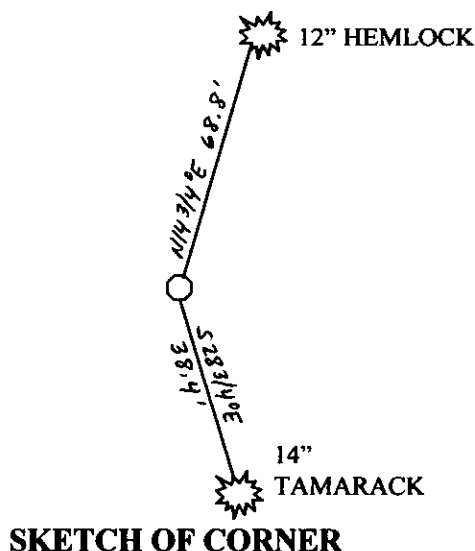
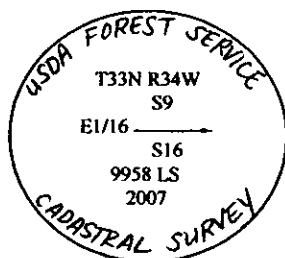

SKETCH OF CORNER

CERTIFICATION

I, James R. Staples
Certify the information shown herein is true and correct.

James R. Staples
Signature Ground Party Chief

I, James R. Staples
certify that this Corner Record correctly represents work performed by me or under my direction in compliance with the "Corner Recordation Act" (70-22-101, et seq., M.C.A.)

James R. Staples
Signature of Surveyor & Seal

Date: 7-13-07 Reg. No. 9958LS

Employer: J.R.S. Surveying, Inc.

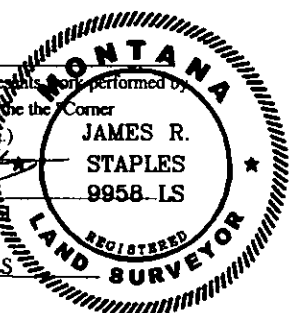

Office of Clerk and Recorder

This Record

204578 BOOK: CCR CC&R'S PAGE: 11070 Pages: 1

record" was filed for STATE OF MONTANA LINCOLN COUNTY

RECORDED: 07/25/2007 10:15 KOI: CC&R'S

was noted on the cross: TAMMY D. LAUER CLERK AND RECORDER

book no. FEE: \$0.00

TO: FILED

BY: Kyle Blomdahl, Deputy

County Official

Cross Index No. J12 T. 33N R. 34W PMM

Adopted July 1, 1981, Montana Board of Professional Engineers & Land Surveyors

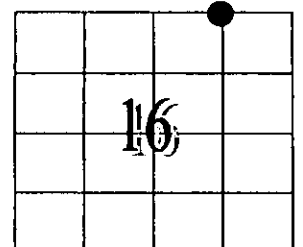

• - Corner this sheet