

INSTRUCTIONS

1. Original and/or subsequent record used to evaluate the corner position.
2. Description of evidence found, note discrepancies in the record, state method of establishing lost or obliterated corners.
3. Description of monument and accessories set to perpetuate the corner position.
4. Sketch of corner, show all pertinent data which can best be shown in a sketch example, corner marking, topography ties, position of accessories, etc.
5. Certification must be signed and sealed by Land Surveyor registered in the State of Montana.
6. Fill in Cross Index & Section Diagram at bottom of sheet.

CERTIFIED CORNER RECORDATION

Corner NW-SE-NE 1/256 SEC. 16 T. 33N R. 34W P.M.M. Lincoln County

The new corner monument was established as a result of a subdivisioal survey of the Section. Said subdivisiional survey was made in accordance with methods and procedures contained in the Manual of Surveying Instructions (1973); U.S. Bureau of Land Management.

FOUND:

A 5/8" rebar with plastic cap -- Hughes 7322LS within positional tolerance.

ESTABLISHED:

Replaced plastic cap with a 3 1/4" aluminum cap on found rebar, marked as shown below; from which:

A 9" pine bears S41 1/4°E, 45.6 feet, scribed "X" BT.

A 16" pine bears N42°W, 18.5 feet, scribed 1/256 S16 BT.

Set a 6' metal post, with land survey monument decal attached, 2.0 feet south and 2.0 feet west of monument.

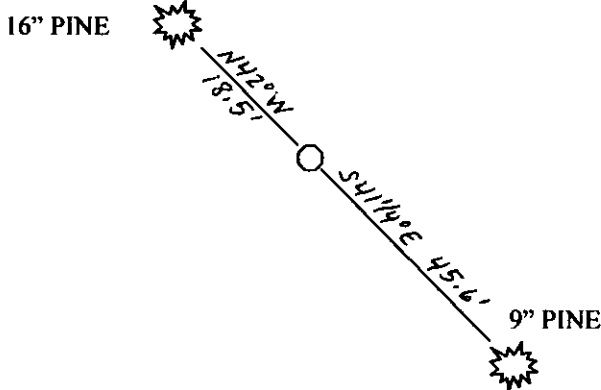
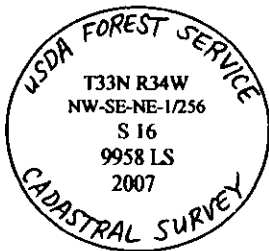

SKETCH OF CORNER

CERTIFICATION

I, James R. Staples
Certify the information shown herein is true and correct.

James R. Staples
Signature Ground Party Chief

I, James R. Staples
certify that this Corner Record correctly represents work performed by me or under my direction in compliance with the "Corner Recordation Act" (70-22-101, et seq., M.C.A.)

James R. Staples
Signature of Surveyor & Seal

Date: 7-13-07 Reg. No. 9958LS

Employer: J.R.S. Surveying, Inc.

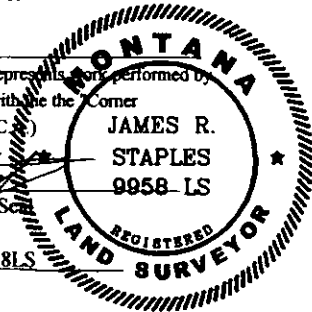

Office of Clerk and Recorder, County of

204575 BOOK: CCR CC&R'S PAGE: 11067 Pages: 1

record" was filed in STATE OF MONTANA LINCOLN COUNTY

was noted on the cr RECORDED: 07/25/2007 10:00 KOI: CC&R'S

book no. TAMMY D. LAUER CLERK AND RECORDER

FEE: \$0.00

BY: Jul Blomdell, deputy

TO: FILED

County Official

Cross Index No. FF27 T. 33N R. 34W PMM

Adopted July 1, 1981, Montana Board of Professional Engineers & Land Surveyors

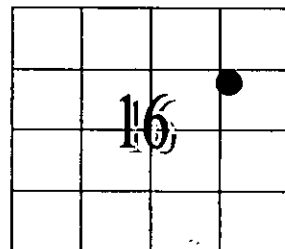

• - Corner this sheet