

INSTRUCTIONS

1. Original and/or subsequent record used to evaluate the corner position.
2. Description of evidence found, not discrepancies in the record, state method of establishing lost or obliterated corners.
3. Description of monument and accessories set to perpetuate the corner position.
4. Sketch of corner, show all pertinent data which can best be shown in a sketch example, corner marking, topography ties, position of accessories, etc.
5. Certification must be signed and sealed by Land Surveyor registered in the State of Montana.
6. Fill in Cross Index & Section Diagram at bottom of sheet.

CERTIFIED CORNER RECORDATION

Corner NW-CC Sec 17/ SW-CC Sec 8 T. 33N R. 34W P.M.M. Lincoln County

- 1) Original Record- GLO 1903
Intersect Montana- Idaho Boundary Line 34.25 chains (2260.5') south of Post No. 36, 24.965 inches; which is an iron post, 3' above ground marked and witnessed as described by the surveyor general. Set a granite stone, 21"x16"x5", 16" in the ground for closing corner of Sections 8 and 17, marked M, CC on East, I on West, with 4 grooves on South and 2 grooves on North faces, from which:

A Cedar, 7" diameter, bears N21°30'E, 14 links (9.24') distant, marked T33N R34W S8 BT.
A Cedar, 10" diameter, bears S53°30'E, 9 links (5.94') distant, marked T33N R34W S17 BT.

- 2) No evidence found. Corner position is in highway fill slope.

- 3) Set a standard Forest Service aluminum monument on line between milepost monuments #36 and #37 at a proportional record distance from milepost #36, marked as shown:

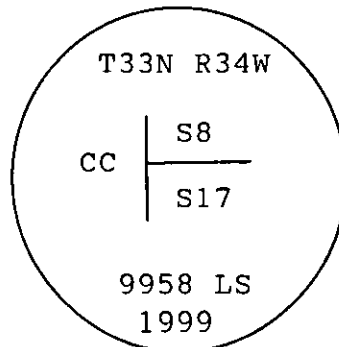

From which:

A 14" Douglas Fir, bears S79°E, 125.3' distant and scribed T33N R34W CC S17 BT.
A 13" Ponderosa Pine, bears N70°E, 88.2' distant and scribed T33N R34W CC S8 BT.

A 6' steel post with a Land Survey monument decal attached, was placed 1' east from monument. Blazes and scribing on bearing trees were painted red. Bearing tree tags and Land Survey monument signs were attached to trees.

CERTIFICATION

I, Kevin Todd

certify the information shown herein is true and correct.

Kevin Todd
Signature Ground Party Chief

I, James R. Staples

certify that this corner Record correctly represents work performed by me or under my direction in compliance with the "Corner Recordation Act" (70-22-101, et seq., M.C.A.)

James R. Staples
Signature of Surveyor & Seal

Date: 5-3-99 Reg. No. 9958

Employer: J.R.S. Surveying, Inc.

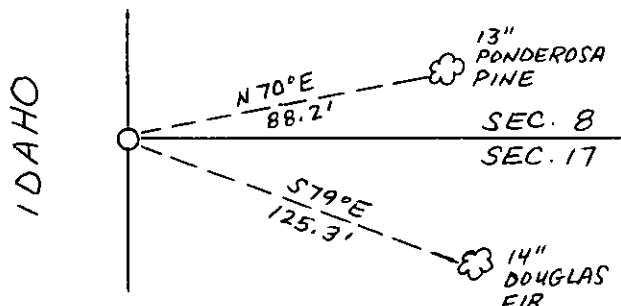
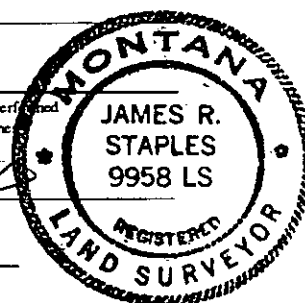

SKETCH OF CORNER

Office of Clerk and Recorder, County of Lincoln. This "corner record" was filed for record on May 3, 1999 was noted on the cross-index plat and is assigned page No. in book No. 10323

Coral M. Cummings
County Official Deb

Sec. 17

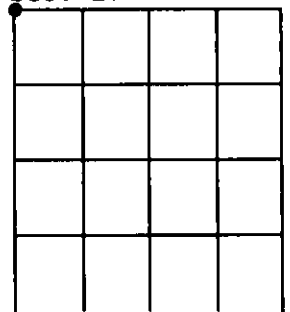

Cross Index No. J-5 T. 33N R. 34W PMM