

# CERTIFIED CORNER RECORDATION

Corner CC Secs. 20&29 T. 33N R. 34W P.M., MT Lincoln County

- I. 1912 G.L.O. Record by William C. Perkins: Intersect the Idaho-Montana State Line, 56 lks. North of monument no. 40, which is an iron post, 6 ft. long, 4 ins. diam., firmly set, mkd. and witnessed as described by the Surveyor General. At the point of intersection, I set a granite stone, 16x16x6 ins., 11 ins. in the ground for the closing cor. of secs. 20 and 29, mkd. "CC" on E. face, with 2 grooves on S. and 4 grooves on N. face.

Established two bearing trees:

- A fir, 18 ins. diam., bears N20°E, 85 lks. dist., mkd "T33N R34W S20 BT".  
A fir, 20 ins. diam., bears S88°E, 31 lks. dist., mkd "T33N R34W S29 BT".

- II. Found stone, 13x12 ins., protruding 8 ins. above the ground, mkd. with 4 notches on N. face, 2 notches on S. face, "CC" on N.E. face.

from which:

- A rotten fir stump, bears N20°E, 56.1 ft. dist., no visible scribe. (record)  
A rotten fir stump, bears S88°E, 20.5 ft. dist., with visible scribe. (record)

- III. At the exact corner position, as determined by the found original stone and witnessed by the remains of the original bearing trees, set a 2 1/2 in. diam. aluminum pipe, 30 ins. long, 24 ins. in the ground, with a 3 1/4 in. diam. aluminum cap, mkd. as shown.

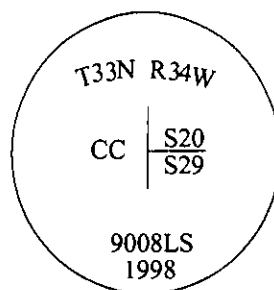

Established two new bearing trees:

- A hemlock, 11 ins. diam., bears N48°E, 26.3 ft. dist., mkd. "T33N R34W CC S20 BT".  
A hemlock, 8 ins. diam., bears S22°E, 35.3 ft. dist., mkd. "T33N R34W CC S29 BT".

Bury the original stone alongside the aluminum pipe.

Painted bearing trees and attached Land Survey Monument and Bearing Tree signs.

Magnetic Declination: 20° East

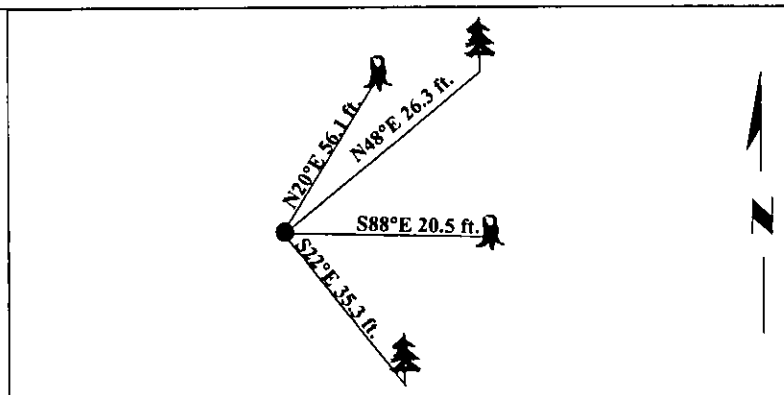

SKETCH OF CORNER

CERTIFICATION

I, Thomas M. Hommel  
certify the information shown herein is true and correct.

I, Ronald A. Pearson  
certify that this Corner Record correctly represents work performed by me or under my direction in compliance with the "Corner Recordation Act" (70-22-101, et seq., M.C.A.)

Signature of Surveyor & Seal

Date: 5/14/98

Reg. No.: 9008LS

Employer: U.S. FOREST SERVICE

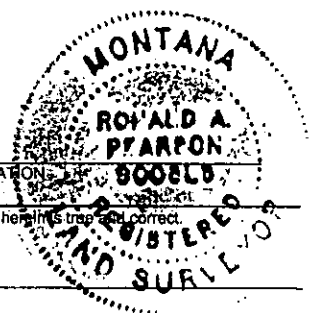

Office of Clerk and Recorder, County of Lincoln. This "corner record" was filed for record on 8-3-98 and was noted on the cross-index plat and is assigned page No. 10135 in book No. \_\_\_\_\_.

Coral M. Cummings By DLB  
County Official

Sec. 29

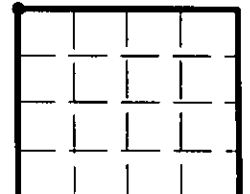

• - corner this sheet