

# CERTIFIED CORNER RECORDATION

Corner WCMC Secs. 20&29 T. 33N R. 34W P.M., MT Lincoln County

- I. 1912 G.L.O. Record by William C. Perkins: Set a slate stone, 18x10x10 ins. 14 ins. in the ground, for witness corner to the secs and meander cor., mkd. "WCMC" on N.E. face, with 2 notches on the S. and 4 notches on the E. edge.

Established two bearing trees:

A tamarack, 5 ins. diam., bears S74°W, 92 lks. dist., mkd "WCMC T33N R34W S29 BT".  
A willow, 6 ins. diam., bears N36°W, 4 lks. dist., mkd "WCMC T33N R34W S20 BT".

- II. No evidence of original stone, found one bearing tree.

from which:

A larch stump, 8 ins. diam., bears S74°W, 60.7 ft. dist., with visible scribe. (G.L.O.-record)

- III. At the corner position, as determined by using record bearing and distance, from the found bearing tree, set a 2 1/2 in. diam. aluminum pipe, 30 ins. long, 2 ins. above a rock collar, with a 3 1/4 in. diam. aluminum cap, mkd. as shown.

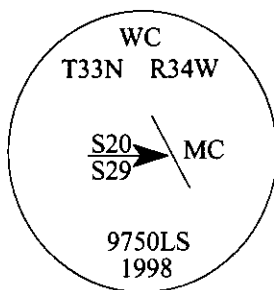

Established two new bearing trees:

A fir, 6 ins. diam., bears S42°W, 26.9 ft. dist., mkd. "WCMC T33N R34W S29 BT".  
A larch, 6 ins. diam., bears N85°W, 28.1 ft. dist., mkd. "WCMC T33N R34W S20 BT".

Painted bearing trees and attached Land Survey Monument and Bearing Tree signs.

Magnetic Declination: 20° East

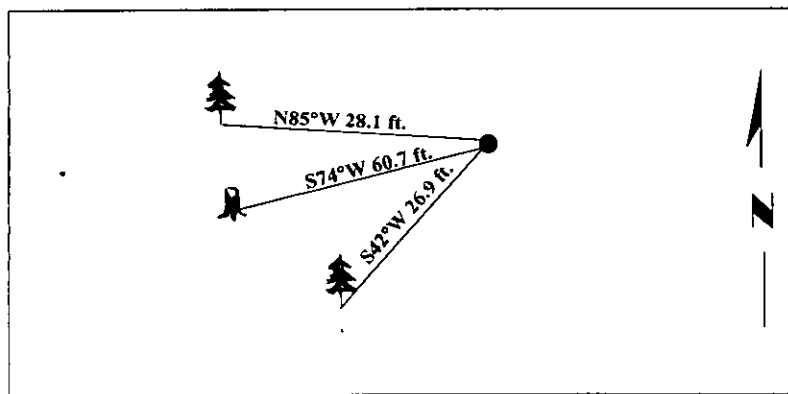

SKETCH OF CORNER

## CERTIFICATION

I, Mark Federman

certify the information shown herein is true and correct.

I, Steven A. Boyer

certify that this Corner Record correctly represents work performed by me or under my direction in compliance with the "Corner Recordation Act" (70-22-101, et seq., M.C.A.)

Steven A. Boyer  
Signature of Surveyor & Seal

Date: 6/10/98

Reg. No.: 9750LS

Employer: U.S. FOREST SERVICE

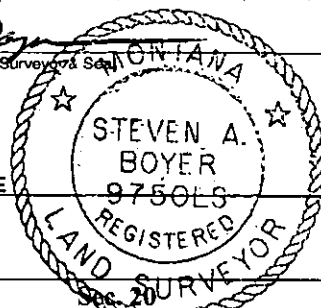

Office of Clerk and Recorder, County of Lincoln. This "corner record" was filed for

record on 21 July 98 and was noted on the cross-index plat and is assigned page No. 10134

in book No. \_\_\_\_\_

Coral M. Hummings  
County Official

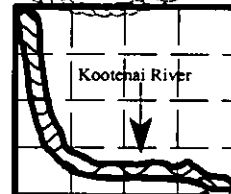

• - corner this sheet

Cross Index No. WCMC T. 33N R. 34W P.M., MT  
S20&S29