

# CERTIFIED CORNER RECORDATION

Corner Boundary Sec. MP 38 T. 33N R. 34W P.M., MT Lincoln County  
Line

- I. 1899 U.S. Geological Survey by D. L. Reaburn, U.S. Surveyor: Set an iron post, 6 ft. long, 4 in. diam., 3 ft. in the ground and deposited charcoal underneath the post. The post is surrounded by a bronze cap which is stamped as shown. Dug pits 3x2x1 1/2 ft. in diam., 4.0 ft. North and South and built mounds of earth, 4.0 ft. East and West of the post.

Established three bearing trees:

A pine, 30 ins. diam., bears N76°E, 56.0 ft. dist., mkd "Mont. P. 38 BT".  
A pine, 24 ins. diam., bears S45°30'E, 29.0 ft. dist., mkd "Mont. P. 38 BT".  
A fir, 15 ins. diam., bears N88°20'W, 50.0 ft. dist., mkd "Idaho P. 38 BT".

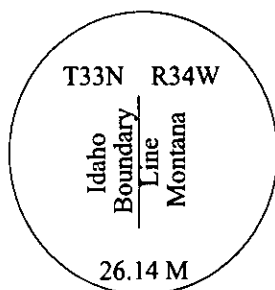

- II. Found a 3 1/2 in. diam. iron pipe, protruding 3 ft. above ground, with a 3 3/4 in. diam. U.S.G.S. brass cap mkd. as shown.

from which:

A pine stump, 28 ins. diam., bears N76°E, 56.0 ft. dist., no visible scribe. (record)  
A rotten fir stump, bears N88°W, 50.0 ft. dist., no visible scribe. (record)  
Pits, North and South, 4.0 ft. dist. of the monument.  
Mounds, East and West, 4.0 ft. dist. of the monument.

- III. Established two new bearing trees:

A fir, 15 ins. diam., bears N65°E, 55.4 ft. dist., mkd. "MONT P 38 BT".  
A fir, 13 ins. diam., bears N17°W, 44.1 ft. dist., mkd. "IDAHO P 38 BT".

Painted bearing trees and attached Land Survey Monument and Bearing Tree signs.

Magnetic Declination: 20° East

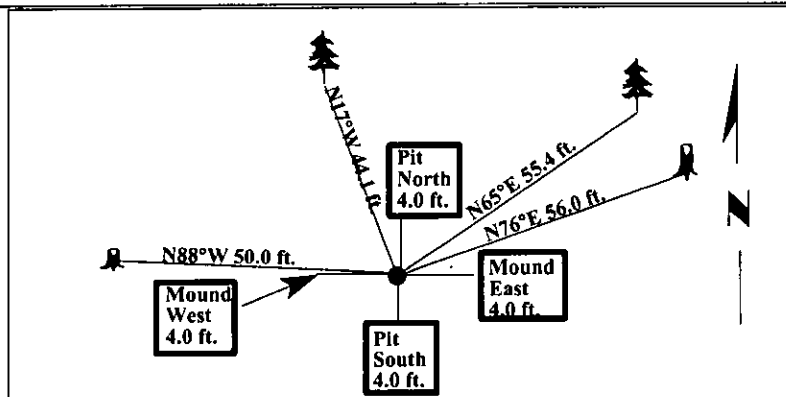

SKETCH OF CORNER

CERTIFICATION

I, Mark Federman  
certify the information shown herein is true and correct.

I, Steven A. Boyer  
certify that this Corner Record correctly represents work performed by me or under my direction in compliance with the "Corner Recordation Act", Pub. Law 96-349, 90 Stat. 1011, 16 U.S.C. 1601, et seq. (M.C.A.)

Steven A. Boyer  
Signature of Surveyor or Seal

Date: 5/18/98

Reg. No.: 9750LS

Employer: U.S. FOREST SERVICE

MONTANA  
STEVEN A. BOYER  
9750LS  
REGISTERED  
LAND SURVEYOR

Office of Clerk and Recorder, County of Lincoln. This "corner record" was filed for record on 21 July 98 and was noted on the cross-index plat and is assigned page No. 10131 in book No. \_\_\_\_\_.

Coral M. Cummings  
County Official

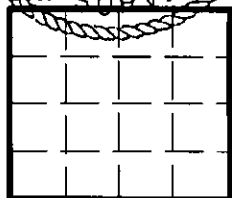

• - corner this sheet

Cross Index No. MP 38 T. 33N R. 34W P.M., MT