

CERTIFIED CORNER RECORDATION

Corner S 1/4 Sec. 31 T. 33N R. 31W P.M., MT Lincoln County

- I. 1904 G.L.O. Original Record by Ranney Y. Lyman et. al: Set a limestone, 14x12x5 ins., 9 ins. in the ground, for standard 1/4 sec. cor., mkd. "SC 1/4" on the N. face. Established two bearing trees.

1976 B.L.M. Remonumentation Record by Joseph E. French: The Standard 1/4 sec. cor. of sec. 31 on the S. boundary of the Township, monumented with a limestone, 14x12x5 ins., firmly set, 9 ins. in the ground, mkd. "SC 1/4" on the N. face, and witnessed by the remains of the original bearing trees. At the corner point, set an iron post, 30 ins. long, 2 1/2 ins. diam., 24 ins. in the ground, with brass cap mkd. as shown.

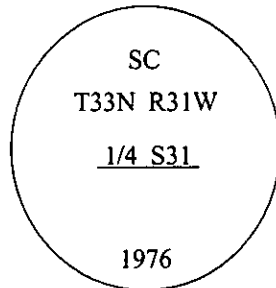

Established two new bearing trees and buried the original stone alongside and raise a flat mound of stone, 2.0 ft. diam., around the iron post.

- II. Found a brass cap, protruding 5 ins. above the ground, firmly set, with a small rock collar, mkd. as shown above. Found the GLO and BLM bearing trees.

from which:

- A rotted stump, bears N17°E, 16.5 ft. dist., "4 S31 SC" visible. (G.L.O.-record)
- A pine, 15 ins. diam., bears S83°E, 34.98 ft. dist., with a pirtched over face. (B.L.M.-record)
- A pine, 14 ins. diam., bears N13°W, 34.32 ft. dist., "1/4 S31 BT" visible. (B.L.M.-record)
- A down tree, bears N33°W, 13.2 ft. dist., "SC 1/4 S31 BT" visible. (G.L.O.-record)

- III. Painted bearing trees and attached Land Survey Monument and Bearing Tree signs.

Magnetic Declination: 20° East.

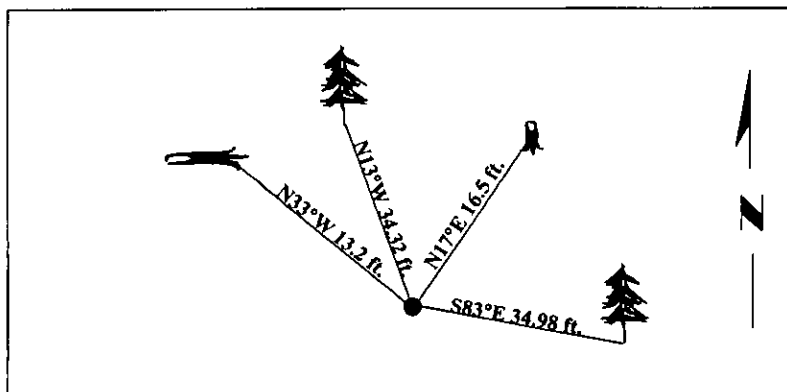

SKETCH OF CORNER

CERTIFICATION

I. Thomas Hommel
certify the information shown herein is true and correct.

I. Ronald A. Pearson
certify that this Corner Record correctly represents work performed by me or under my direction in compliance with the "Corner Recordation Act" (70-22-101 et seq., M.C.A.)

Signature of Surveyor & Seal

Date: 1/21/98

Reg. No.: 9008LS

Employer: U.S. FOREST SERVICE

RONALD A. PEARSON
9008LS
REGISTERED
SURVEYOR

Office of Clerk and Recorder, County of Lincoln. This "corner record" was filed for record on 1-21-98 was noted on the cross-index plat and is assigned page No. 10071 in book No. _____

Coral M. Cumming By SCB
County Official

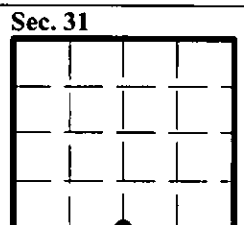

● - corner this sheet

Cross Index No. Z-3 T. 33N R. 31W P.M., MT

REC-100
FBI
OCT 10 1964
FBI
OCT 10 1964