

# CERTIFIED CORNER RECORDATION

Corner Sec. Cor. Sec. SW S31 T. 33N R. 31W P.M., MT Lincoln County

- I. 1904 G.L.O. Original Record by Ranney Y. Lyman et. al: Set a limestone, 18x8x6 ins., 12 ins. in the ground, for cor. of T31N, and R31 & 32W, mkd "SC" on N., with 6 grooves on N., E., and W. faces. Established two bearing trees.

1976 B.L.M. Remonumentation Record by Joseph E. French: The Standard cor. of T33N, R31 & 32W, monumented with a limestone, 18x8x6 ins., firmly set, 12 ins. in the ground, mkd. "SC" on the N. and 6 grooves on the N., E. and W. faces, witnessed by the remains of the original bearing trees. At the corner point, set an iron post, 30 ins. long, 2 1/2 ins. diam., 24 ins. in the ground, with brass cap mkd. as shown.

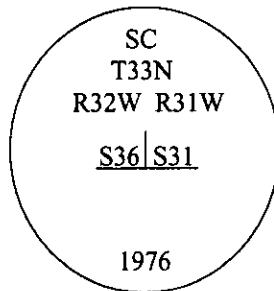

Established two new bearing trees and buried the original stone alongside and raise a flat mound of stone, 3.0 ft. diam., around the iron post.

- II. Found a brass cap, firmly set, with a small rock collar, mkd. as shown above. Found two bearing trees.  
from which:

A fir, 12 ins. diam., bears N61 1/2°E, 65.34 ft. dist., "T33N R31W S31 SC BT" visible. (B.L.M.-record)  
A fir, 15 ins. diam., bears N77°W, 19.14 ft. dist., with a healed face. (B.L.M.-record)

- III. Set a steel galvanized post, East, 4.0 ft. dist of corner, with Land Survey Monument and Property Boundary decals attached.  
Painted bearing trees and attached Land Survey Monument and Bearing Tree signs.  
Attached a location poster to a fir tree on the uphill side of road No. 4604.

Magnetic Declination: 20° East.

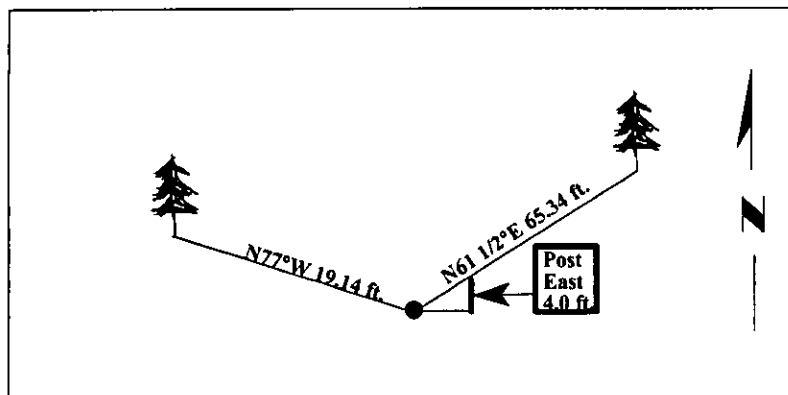

SKETCH OF CORNER

CERTIFICATION

I, Thomas Hommel  
certify the information shown herein is true and correct.

I, Ronald A. Pearson  
certify that this Corner Record correctly represents work performed by me or under my direction in compliance with the "Corner Recordation Act" (70-22-101, et seq., M.C.A.)

Signature of Surveyor & Seal

Date: 1/21/98

Reg. No.: 9008LS

Employer: U.S. FOREST SERVICE

REGISTERED LAND SURVEYOR

Office of Clerk and Recorder, County of Lincoln. This "corner record" was filed for record on 1-21-98 was noted on the cross-index plat and is assigned page No. 10070 in book No. \_\_\_\_\_

Coral M. Cumming By ALB  
County Official

Sec. 31

• - corner this sheet

RECEIVED  
JAN 10 1964  
FBI - NEW YORK  
COMMUNICATIONS SECTION  
TELETYPE UNIT