

# CERTIFIED CORNER RECORDATION

Corner S 1/16 S15 T 33 N. R. 31 W. P.M.M. Lincoln County

I. Record: None

II. Found: No monuments found during area search.

III. Perpetuation: At the corner point, determined by survey, set a 5/8 ins. diam. steel rebar 24 ins. long, 22 ins. in the ground, with a 3 1/4 ins. diam. U.S.D.A Aluminum cap marked as shown below from which:

A pine, 8 ins. diam., bears S. 63°E., 7.40 ft. dist., scribed X WC BT.

A pine, 5 ins. diam., bears N. 52°30'W., 7.10 ft. dist., scribed X WC BT.

Painted faces and 6 in. wide red bands to all bearing trees and attached Land Survey Monument and Bearing Tree signs.

Raise a collar of stone, 1 ft. base 1 ft. high around set monument.

Set a steel post on line 2 ft. North of set monument with attached Land Survey Monument and Property Boundary stickers.

Magnetic declination: 18° East

Equipment used: Hand compass and loggers tape

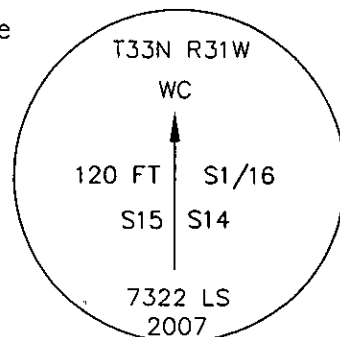

Kootenai Surveyors Inc., 314 California Av., Libby, MT. 59923 (406) 293-4354

CRUIEN CR. - PCTC

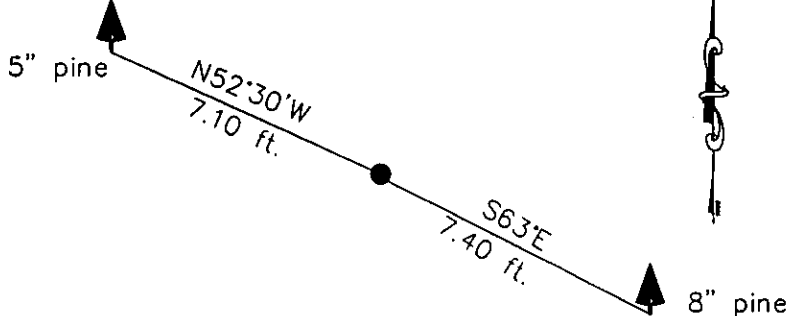

SKETCH OF CORNER

CERTIFICATION

I, Levi Powell certify the information shown herein is true and correct.

Levi Powell Signature Ground Party Chief

I, Alvah F. Hughes certify that this Corner Record correctly represents work performed by me or under my direction in compliance with the "Corner Recordation Act" (70-22-101, et seq., M.C.A.)

Alvah F. Hughes Signature of Surveyor & Seal

Date: 7/29/2007 Reg. No. 7322-LS

Employer: Kootenai Surveyors Inc.

Office of Clerk and Recorder, County of Lincoln This "corner

record" was filed for record on

205589 BOOK: CCR CC&R'S PAGE: 11113 Pages: 1

was noted on the cross-index STATE OF MONTANA LINCOLN COUNTY

book No. RECORDED: 08/27/2007 9:35 KOI: CC&R'S

TAMMY D. LAUER CLERK AND RECORDER

FEE: \$0.00

BY: Tammy D. Lauer

TO: KOOTENAI SURVEYORS INC. P.O. BOX 393, LIBBY, MT 59923

Cross Index No. M 17 T. 33N R. 31W P.M., MT

Adopted July 1, 1981, Montana Board of Professional Engineers & Land Surveyors

Sec. 15

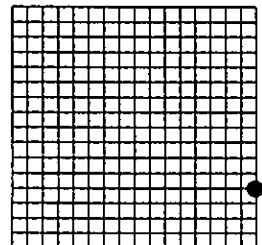

• corner this sheet

