

CERTIFIED CORNER RECORDATION

Corner CE 1/16 S15 T 33 N. R. 31 W. P.M.M. Lincoln County

I. Record: None

II. Found: No monuments found during area search.

III. Perpetuation: At the corner point, determined by survey, set a 5/8 ins. diam. steel rebar 24 ins. long, 22 ins. in the ground, with a 3 1/4 ins. diam. U.S.D.A Aluminum cap marked as shown below from which:

A fir, 11 ins. diam., bears S. 6° E., 11.15 ft. dist., scribed CE 1/16 S15 BT.

A fir, 9 ins. diam., bears N. 72° W., 20.55 ft. dist., scribed CE 1/16 S15 BT.

Painted faces and 6 in. wide red bands to all bearing trees and attached Land Survey Monument and Bearing Tree signs.

Raise a collar of stone, 4 ft. base 1 ft. high around set monument.

Set a steel post on line 2 ft. South of set monument with attached Land Survey Monument and Property Boundary stickers.

Magnetic declination: 18° East

Equipment used: Hand compass and loggers tape

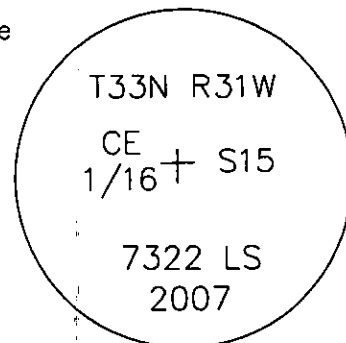

Kootenai Surveyors Inc., 314 California Av., Libby, MT. 59923 (406) 293-4354

CRUIEN CR. - PCTC

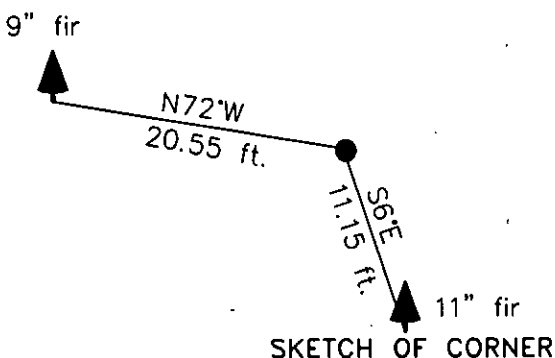

CERTIFICATION MONTANA

Levi Powell
certify the information shown herein is true and correct.

Alvah F. Hughes
Signature Ground Party Chief 7322LS

Alvah F. Hughes
certify that this Corner Record correctly represents work performed by me or under my direction in compliance with the "Corner Recordation Act" (70-22-101, et seq., M.C.A.)

Alvah F. Hughes
Signature of Surveyor & Seal

Date: 7/24/2007 Reg. No. 7322-LS

Employer: Kootenai Surveyors Inc.

Office of Clerk and Recorder, County of Lincoln. This "corner

record" was filed for record on _____
was noted on the cross-index
book No. _____

205583 BOOK: CCR CC&R'S PAGE: 11107 Pages: 1
STATE OF MONTANA LINCOLN COUNTY
RECORDED: 08/27/2007 9:25 KOI: CC&R'S
TAMMY D. LAUER CLERK AND RECORDER
FEE: \$0.00 BY: *Leanne Reuter*
TO: KOOTENAI SURVEYORS INC. P.O. BOX 393, LIBBY, MT 59923

Cross Index No. L 16 T. 33N R. 31W P.M., MT

Adopted July 1, 1981, Montana Board of Professional Engineers & Land Surveyors

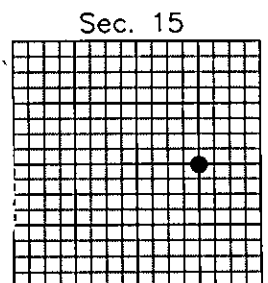

• corner this sheet

10/20/2020

10/20/2020