

CERTIFIED CORNER RECORDATION

Corner SW Cor. S 15 T 33 N. R. 31 W. P.M.M. LINCOLN County

I. Record: 1903 original GLO survey by G. Fessensen and R. Lyman: set a stone and establish four bearing trees.

1970 BLM Remoumentation by J. French: Set an iron post, 30 ins. long, 2 1/2 ins. diam., 26 ins. in the ground, with brass cap mkd. as shown below from which:

- A larch, 6 ins. diam., bears N. 24°30'E., 19 lks. dist., mkd. T33N R31W S15 BT.
- A larch, 6 ins. diam., bears S. 57°E., 8 lks., dist., mkd. T33N R31W S22 BT.
- A larch, 7 ins. diam., bears S. 89°30'W., 20 lks., dist., mkd. T33N R31W S21 BT.
- A larch, 6 ins. diam., bears N. 40°30' W., 34 lks. dist., mkd. T33N R31W S16 BT.

II. Found: A 3 1/4 ins. diam. BLM brass cap on a 2 1/2 in. diam. iron pipe firmly set from which:

- A larch snag, 8 ins. diam., bears N. 24°30'E., 12.65 ft. with overgrown face.
- A larch, 6 ins. diam., bears S. 57°E., 5.20 ft. dist., with overgrown face..
- A larch snag, 8 ins. diam., bears S. 89°W., 13.20 ft. dist., with overgrown face.
- A larch, 8 ins. diam., bears N. 40°30'W., 22.50 ft. dist., with overgrown face.

III. Perpetuation: Establish two bearing trees described below:

- A fir, 14 ins. diam., bears N. 79°E., 25.30 ft. dist., mkd. T33N R31W S15 BT.
- A pine, 10 ins. diam., bears S. 40°W., 10.10 ft. dist., mkd. T33N R31W S21 BT.

Painted faces and 6 in. wide red bands to all bearing trees and attached Bearing tree and Land Survey Monument signs.

Set a steel post on line 3.0 ft. North of corner with attached Land Survey Monument and Property Boundary stickers.

Magnetic declination: 18° East

Equipment used: Hand compass and loggers tape

Kootenai Surveyors Inc., 314 California Av., Libby, MT. 59923 (406) 293-4354

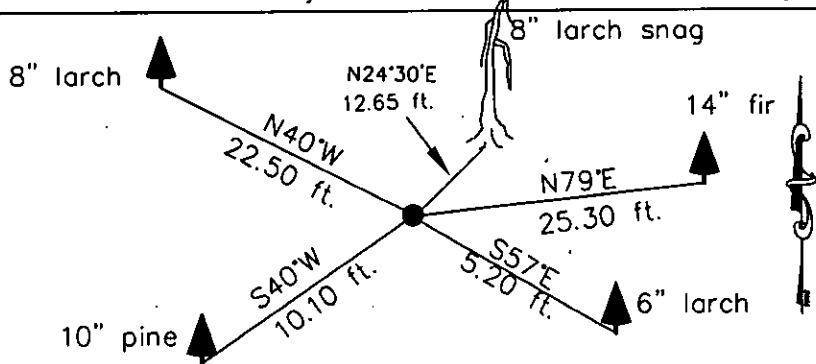

CRUIEN CR. -PCTC

SKETCH OF CORNER

CERTIFICATION

ALVAH F. HUGHES

Levi Powell

Signature Ground Party Chief

Alvah F. Hughes

Signature of Surveyor & Seal

Date: 07/24/2007 Reg. No. 7322-LS

Employer: Kootenai Surveyors Inc.

Office of Clerk and Recorder, County of Lincoln This "corner

record" was filed for record on 205581 BOOK: CCR CC&R'S PAGE: 11105 Pages: 1

was noted on the cross-index STATE OF MONTANA LINCOLN COUNTY

book No. RECORDED: 08/27/2007 9:15 KOI: CC&R'S

TAMMY D. LAUER CLERK AND RECORDER

FEE: \$0.00 BY: [Signature]

TO: KOOTENAI SURVEYORS INC. P.O. BOX 393, LIBBY, MT 59923

Cross Index No. N 13 T. 33N R. 31W P.M., MT

Adopted July 1, 1981, Montana Board of Professional Engineers & Land Surveyors

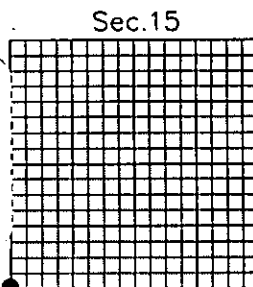

• corner this sheet



1945

1945