

## INSTRUCTIONS

1. Original and/or subsequent record used to evaluate the corner position.
2. Description of evidence found, note discrepancies in the record, state method of establishing lost or obliterated corners.
3. Description of monument and accessories set to perpetuate the corner position.
4. Sketch of corner, show all pertinent data which can best be shown in a sketch example, corner marking, topography ties, position of accessories, etc.
5. Certification must be signed and sealed by Registered Land Surveyor in State of Montana.
6. Fill in Cross Index & Section Diagram at bottom of sheet.

## CERTIFIED CORNER RECORDATION

Corner CSSW 1/64 Section 28 T. 33N R. 27W P.M.M. Lincoln County

RECORD: No previous record of corner monumentation on file.

FOUND: Nothing to show evidence of a previously monumented corner.

SET: A 30" aluminum rod approximately 27" in the ground with a 3 1/4" diameter aluminum cap surrounded by mound of stones and adjacent to an 11" fir on east side, cap is marked as shown.

from which

A pine, 10" diameter, bears S. 88°W., 7.1 feet distance., scribed "1/64 BT".

A pine, 13" diameter, bears S. 11°E., 43.4 feet distance, scribed "1/64 BT".

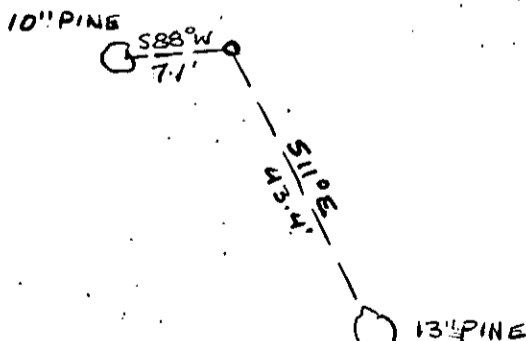
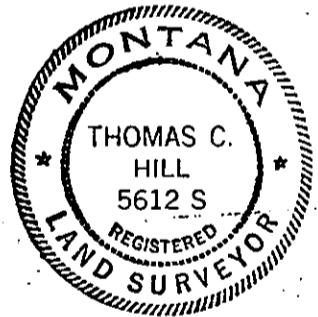
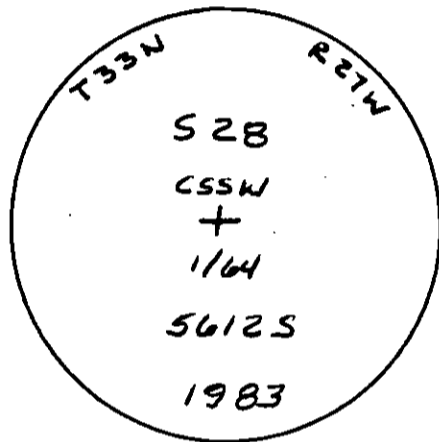

SKETCH OF CORNER

## CERTIFICATION

I, James W. Reed

certify the information shown herein is true and correct.

James W. Reed  
Signature Ground Party Chief

I, Thomas C. Hill

certify that this Corner Record correctly represents work performed by me or under my direction in compliance with the "Corner Recordation Act" (70-22-101, et seq., M.D.A.)

Thomas C. Hill  
Signature of Surveyor & Seal

Date: 6/28/83 Reg. No. 5612 S

Employer: U.S.F.S.

Office of Clerk and Recorder, County of Lincoln. This "corner record" was filed for record on the July 12<sup>th</sup> day of 1983 was noted on the cross-index plat and is assigned page No. 2260, in book No. Janet B. Siegel by Betty L. Conner, deputy

County Official

Sec. 28

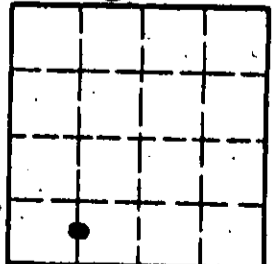

Cross Index No. \_\_\_\_\_ T. 33 R. 27 P.M.M.

• corner this sheet

