

## INSTRUCTIONS

1. Original and/or subsequent record used to evaluate the corner position.
2. Description of evidence found, note discrepancies in the record, state method of establishing lost or obliterated corners.
3. Description of monument and accessories set to perpetuate the corner position.
4. Sketch of corner, show all pertinent data which can best be shown in a sketch example, corner marking, topography ties, position of accessories, etc.
5. Certification must be signed and sealed by Land Surveyor registered in the State of Montana.
6. Fill in Cross Index & Section Diagram at bottom of sheet.

## CERTIFIED CORNER RECORDATION

Corner NW Sec. Cor. of Sec. 6 T. 32 N. R. 33 W. P.M.M. Lincoln County

- I. 1903 G.L.O. original record by A. B. BENEDICT: Set a limestone 21x16x8 ins., 16 ins. in the ground, for closing cor. of Tps. 32N., R. 33 and 34 W., marked CC on S., with 6 grooves on S., E., W. faces; from which:

A pine, 8 ins. diam., bears S66°E, 19 lks. dist., mkd T32N R33W S6 BT.  
 A pine, 8 ins. diam., bears S66°E, 19 lks. dist., mkd T32N R34W S1 BT.  
 (Original notes appear to have a typo with the SW BT.)

- II. Found a stone, 12x7 ins., 14 ins. above ground, pushed out of position, mkd. "CC" on S. face with 6 grooves on S., E., and W. faces, from which:

A pine stump, bears S66°E, 12.5 ft. dist., with log lying alongside, "BT" visible.

- III. At the record bearing and distance from found bearing tree, set a 2 1/2 diam. aluminum pipe, 20 ins. in the ground, with a 3 1/4 in. diam. alum. cap, mkd. as shown:

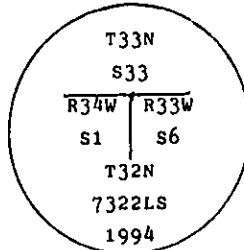

Established two new bearing trees:

A fir, 13 ins. diam., bears S37°E, 10.2 ft. dist., mkd. T32N R33W S6 CC BT.  
 A cedar, 11 ins. diam., bears S62°W, 6.9 ft. dist., mkd. T32N R34W S1 CC BT.

Painted a red band around bearing trees and attached Land Survey Monument and Bearing Tree signs.

Magnetic Declination: 20° East.

## CERTIFICATION

I, Thomas M. Hommel  
 certify the information shown herein is true and correct.

Thomas M. Hommel  
 Signature Ground Party Chief

I, Alvah F. Hughes  
 certify that this Corner Record correctly represents work performed by me or under my direction in compliance with the "Corner Recordation Act" (70-22-10), et seq., M.C.A.

Alvah F. Hughes  
 Signature of Surveyor & Seal

Date: 12/15/94 Reg. No. 7322LS

Employer: U.S. FOREST SERVICE

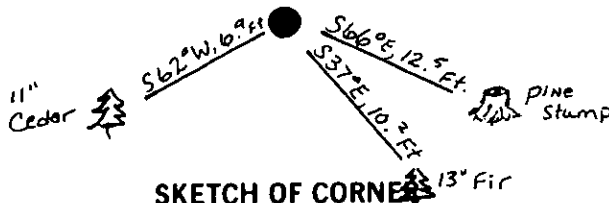

SKETCH OF CORNER

Office of Clerk and Recorder, County of Lincoln. This "corner record" was filed for record on April 27, 1995 was noted on the cross-index plat and is assigned page No. 7023, in book No. Corral M. Cummings & P.B.

County Official

Cross Index No. A-01 T. 32N R. 33W P.M.M.

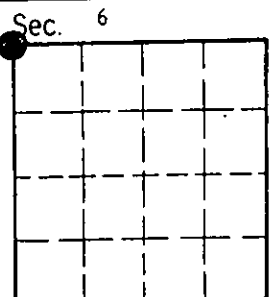

• corner this sheet

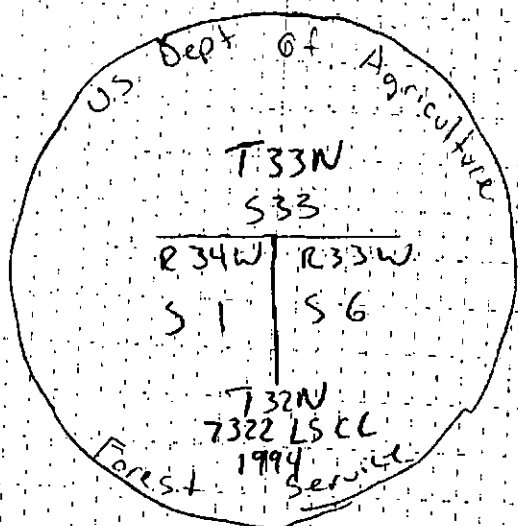

13" DBH Lodgepole  
Pine Scribbled  
T33N R33W S33 CC BT

