

CERTIFIED LAND CORNER RECORDATION

DESCRIPTION OF CORNER EVIDENCE FOUND, AND ORIGINAL RECORD (IF KNOWN)

FOUND: A stone 18 x 8 x 5, 6" out of ground with 4 hash marks on South and 2 on East.

RECORD: Set a limestone 18 x 9 x 5 ins., 12 ins. in the ground....marked with 4 notches on S., and 2 notches on E. edge.

FOUND: 18" Douglas Fir scribed bearing tree at N26°W, 52.1'.
 12" Douglas Fir scribed bearing tree at N68°E, 11'.
 36" Ponderosa Pine scribed bearing tree at S56°E, 56.5'.
 20" Douglas Fir scribed bearing tree at S8°W, 44' (OVER)

DESCRIPTION OF MONUMENT AND ACCESSORIES ESTABLISHED TO PERPETUATE THE ORIGINAL LOCATION OF THIS CORNER:

Date of work: DEC. 3, 1975

CORNER LOCATED USING RECORD DISTANCES FROM BEARING TREES.

We set a 1 1/2" x 30" gal. pipe with brass cap 24" in ground and buried original stone on West side. Brass cap is stamped as per sketch. We built a cairn of rocks around pipe.

We make new reference monuments as per sketch and tag and paint same.

Measurements are to center of tree.

SKETCH, WITH COURSE AND DISTANCE TO ADJACENT CORNERS IF DETERMINED IN THIS SURVEY. (MAY SKETCH OR PASTE REPRODUCTION, ON REVERSE SIDE.)

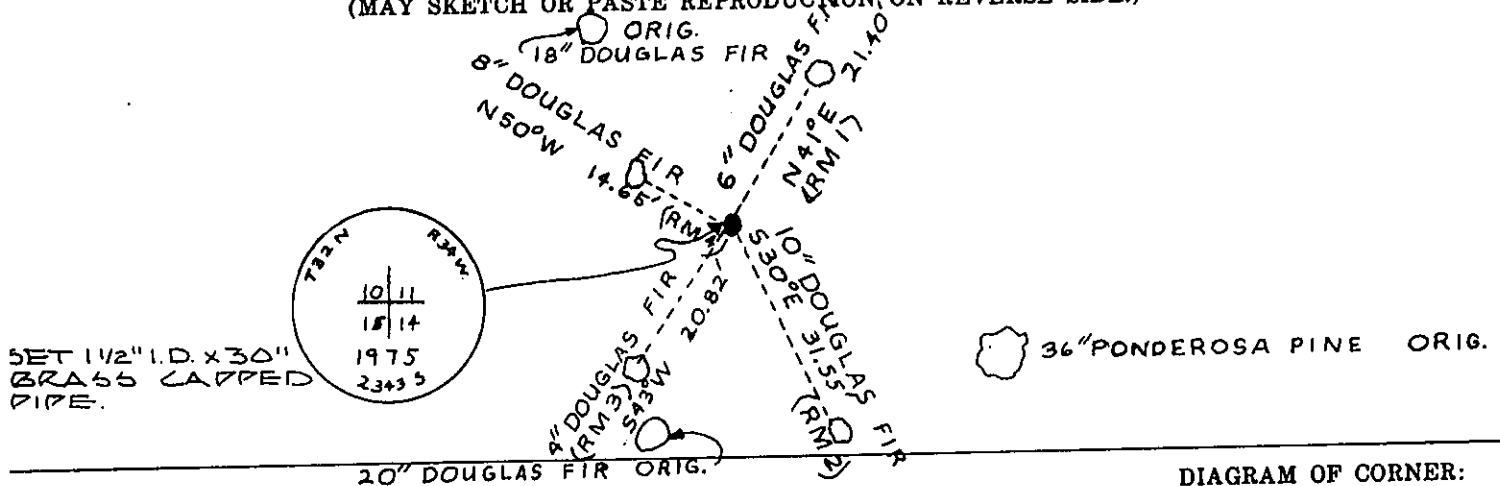

Surveyor's Seal

I, _____
 certify that the information shown herein is true and correct.

Signature of Ground Party Chief

I, J.T. SHAW
 certify that I have carefully performed or reviewed the work done on the diagrammed corner as reported on this recordation form and approve the same.

Signature of Surveyor

DIAGRAM OF CORNER:

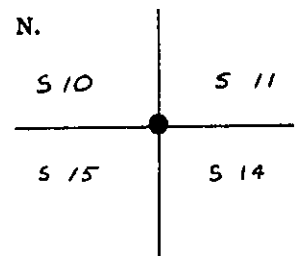

● = Corner recorded on the sheet
 T32N R34W, P.M., M

2343.5
 Registration Number

Office of Clerk and Recorder, County of Lincoln 2:55 p.m.
 his "corner record" was filed for record on the 4th day of March 1976, was noted on the cross-index plat and is assigned page No. 451, in book No. 1
Eleanor Z. Vaughn, by Cherry Davis
 County Official Deputy

Cross Index No. J-17 T. 32 N R. 34 W Mer.

