

INSTRUCTIONS

1. Original and/or subsequent record used to evaluate the corner position.
2. Description of evidence found, note discrepancies in the record, state method of establishing lost or obliterated corners.
3. Description of monument and accessories set to perpetuate the corner position.
4. Sketch or corner, show all pertinent data which can best be shown in a sketch example, corner marking, topography ties, position of accessories, etc.
5. Certification must be signed and sealed by Registered Land Surveyor in State of Montana.
6. Fill in Cross Index & Section Diagram at bottom of sheet.

CERTIFIED CORNER RECORDATION

Corner W. $\frac{1}{4}$ corner of Section 2 T. 32 N R. 34 W P.M.M. Lincoln County

1. 1903 GLO Record: Set a limestone 16x7x5in., 11ins. in the ground, for $\frac{1}{4}$ cor. mkd. $\frac{1}{4}$ on W. face from which:

A pine, 10ins. diam., bears N.64 30 'E., 12 lks. dist., Mkd. $\frac{1}{4}$ S3 BT.

11. I found no original evidence.

111. The corner position was determined as follows:

40.00 Government chains N. of the Southwest Sec. corner.

The corner was set at 40.7182 chains N. of the Southwest Sec. Corner and on line between the CC and the Southwest Sec. cor. of Sec. 2.

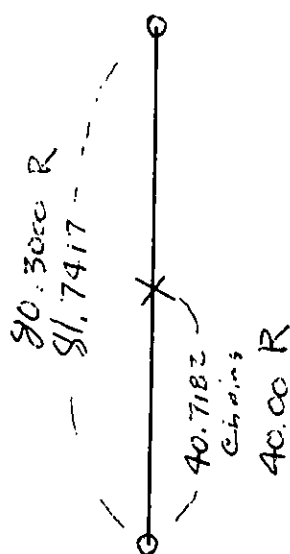

At the corner point:

Set an aluminum post 24ins. long, 2 $\frac{1}{2}$ ins. diam., 20ins. into ground with aluminum cap marked:

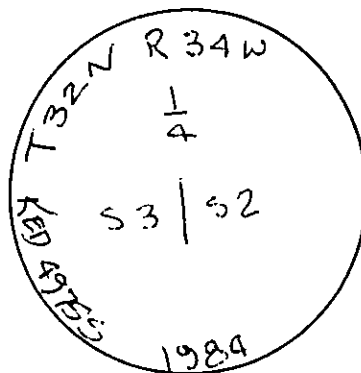

from which:

A red fir 10ins. diam., bears N.25°W., 10 ft. mkd. $\frac{1}{4}$ S3 BT.

A white fir 12ins. diam., bears N.40°E., 5.3 ft. mkd. $\frac{1}{4}$ S2 BT.

- 1V. All bearing trees have a 6in. red band around tree and BT. signs front and back.

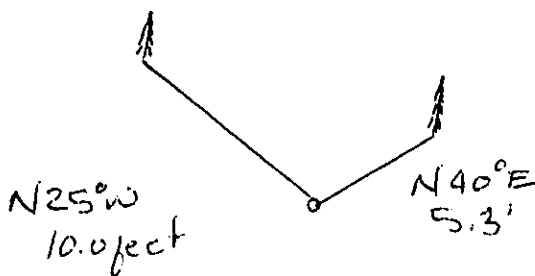
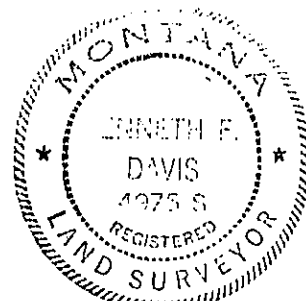

SKETCH OF CORNER

CERTIFICATION

1. Tom D Davis
certify the information shown herein is true and correct.

Signature Ground Party Chief

1. KEN E DAVIS
certify that this Corner Record correctly represents work performed by me or under my direction in compliance with the "Corner Recordation Act" (26-22-10), et seq., M.D.A.)

Signature of Surveyor & Seal

Date: 1984 Reg. No. 4975 S

Employer:

Office of Clerk and Recorder, County of Lincoln. This "corner record" was filed for record on the December 12 day of 1984 was noted on the cross-index plat and is assigned page No. 2840, in book No. _____

James B. F. Siegel by Karen R. Hampe
County Official Deputy

Cross Index No. S. 2 T. 32 R. 34 P.M.M.

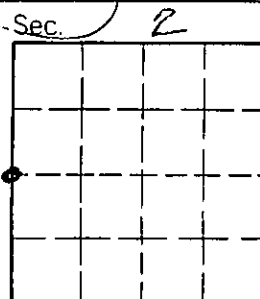

• - corner this sheet

