

INSTRUCTIONS

1. Original and/or subsequent record used to evaluate the corner position.
2. Description of evidence found, note discrepancies in the record, state method of establishing lost or obliterated corners.
3. Description of monument and accessories set to perpetuate the corner position.
4. Sketch or corner, show all pertinent data which can best be shown in a sketch example, corner marking, topography ties, position of accessories, etc.
5. Certification must be signed and sealed by Registered Land Surveyor in State of Montana.
6. Fill in Cross Index & Section Diagram at bottom of sheet.

CERTIFIED CORNER RECORDATION

Corner 1/4 S1 S12 T. 32N R. 34W P.M.M. Lincoln County

- I. From 1967 B.L.M. record: From found original evidence set a 2½"x30" iron post 24" in ground.
From which: A 14" larch bears N44½° E., 55 lks. (new)
A 10" larch bears S61½° W., 60 lks. (new)

- II. Found an iron post 12" above ground with B.L.M. brass cap mkr. as shown:
From which: A 16" larch bears N38° E., 36.6 ft.
Scribing Visible.
A 12" larch bears S58° W., 39.11 ft.
Scribing visible.

- III. Painted red bands around bearing trees.

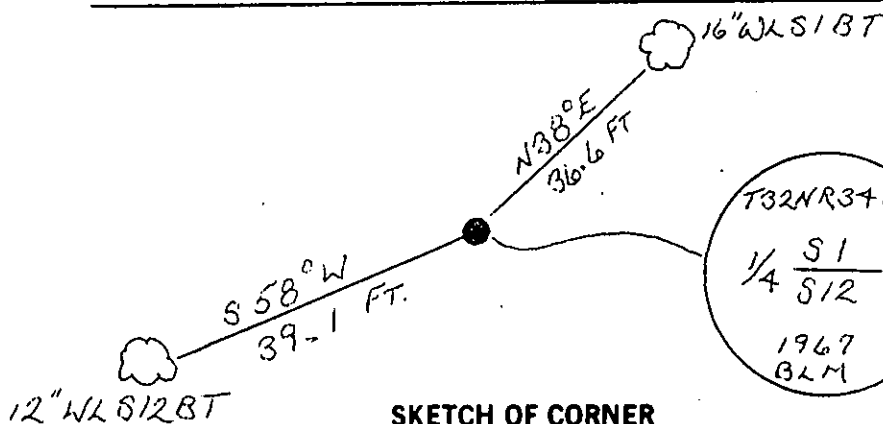

SKETCH OF CORNER

CERTIFICATION
Anthony J. Bachman

I, Anthony J. Bachman
certify the information shown herein is true and correct.

Anthony J. Bachman
Signature Ground Party Chief
Thomas C. Hill

I, Thomas C. Hill
certify that this Corner Record correctly represents work performed by me or under my direction in compliance with the "Corner Recordation Act" (70-22-101, et seq., M.D.A.)

Thomas C. Hill
Signature of Surveyor & Seal

Date: 8-5-82 Reg. No. 5612S

Employer: U.S.F.S.

Office of Clerk and Recorder, County of Lincoln. This "corner record" was filed for record on the Aug. 9th day of 1982 was noted on the cross-index plat and is assigned page No. 1846, in book No. Clearing L. Vaughn by Betty L. Cones

County Official

deputy

E-22

22.1 24.1

Sec. 12

