

## INSTRUCTIONS

1. Original and/or subsequent record used to evaluate the corner position.
2. Description of evidence found, note discrepancies in the record, state method of establishing lost or obliterated corners.
3. Description of monument and accessories set to perpetuate the corner position.
4. Sketch or corner, show all pertinent data which can best be shown in a sketch example, corner marking, topography ties, position of accessories, etc.
5. Certification must be signed and sealed by Registered Land Surveyor in State of Montana.
6. Fill in Cross Index & Section Diagram at bottom of sheet.

## CERTIFIED CORNER RECORDATION

Corner 1/4 S11 | S12 T. 32N R. 34W P.M.M. Lincoln County

I. B.L.M. record 1967: From found original evidence:  
Set a 2½"x30" iron post 24" in ground.

From which: A 6" fir bears S79°W., 8 lks. (new)  
A 15" pine bears S30°15'E., 19 lks. (old)

II. Found an iron pipe 9" above ground with B.L.M. brass cap mrk. as shown:

From which: A 9" fir bears S82°W., 5.7 ft. Healed face.  
A 17" pine bears S23°E., 11.9 ft.

Scribing visible.

Painted red bands around bearing trees.

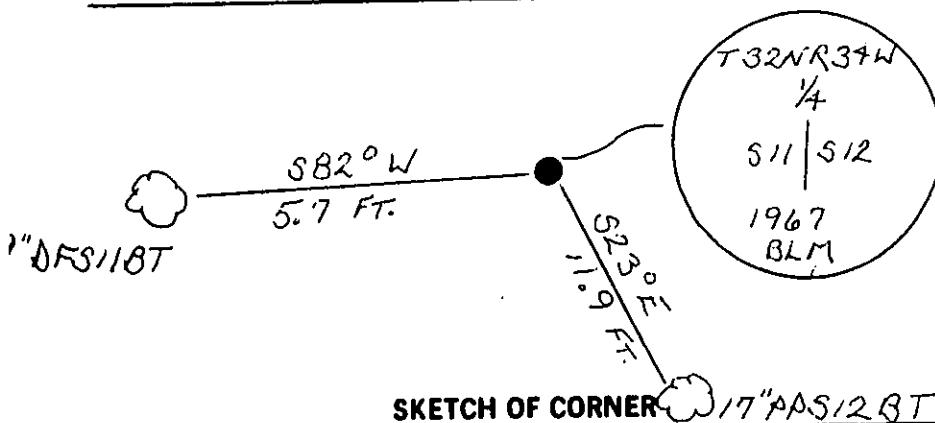
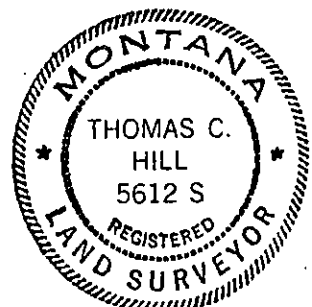

SKETCH OF CORNER 17" PPS12BT

## CERTIFICATION

I, Anthony J. Bachman  
certify the information shown herein is true and correct.

Anthony J. Bachman  
Signature Ground Party Chief  
Thomas C. Hill

I, Thomas C. Hill  
certify that this Corner Record correctly represents work performed  
by me or under by direction in compliance with the "Corner  
Recordation Act" (70-22-101, et seq., M.D.A.)

Thomas C. Hill  
Signature of Surveyor & Seal

Date: 8-5-82 Reg. No. 56125

Employer: U.S.F.S.

Office of Clerk and Recorder, County of Lincoln. This "corner  
record" was filed for record on the Aug. 9th day of 1982

was noted on the cross-index plat and is assigned page No. 1834, in

book No. \_\_\_\_\_

Eleanor L. Vaughn by Betty L. Conces  
County Official deputy

Cross Index No. G-21 T. 32N R. 34W P.M.M.

Sec. 11

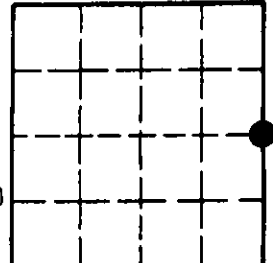

• corner this sheet

