

## INSTRUCTIONS

1. Original and/or subsequent record used to evaluate the corner position.
2. Description of evidence found, note discrepancies in the record, state method of establishing lost or obliterated corners.
3. Description of monument and accessories set to perpetuate the corner position.
4. Sketch or corner, show all pertinent data which can best be shown in a sketch example, corner marking, topography ties, position of accessories, etc.
5. Certification must be signed and sealed by Registered Land Surveyor in State of Montana.
6. Fill in Cross Index & Section Diagram at bottom of sheet.

## CERTIFIED CORNER RECORDATION

Corner Section S2 S1 S11 S12 T. 32N R. 34W P.M.M. Lincoln County

- I. Original G.L.O. record: Set a 12"x9"x6" limestone 8" in ground. Mrk. with 5 notches on South and 1 notch on East edge.

From which: A 9" fir bears N21°30'E., 39 lks. Mrk.: "T32NR34WS1BT."  
An 8" fir bears S40°15'E., 15 lks. Mrk.: "T32NR34WS12BT."  
A 10" larch bears S40°15'W., 54 lks. Mrk.: "T32NR34WS11BT."  
An 8" fir bears N45°15'W., 25lks. Mrk.: "T32NR34WS2BT."

- I. Found a 9"x6" limestone 5" above ground with 5 slashes on South face.

From which: A 12" fir bears S23°E., 9.9 ft. Scribing visible.  
A 14" fir bears N20°E., 25.9 ft. Scribing visible.  
A 14" fir bears N45°W., 16.7 ft. Healed Face.  
A 14" larch bears S40°W., 36.1 ft. Scribing visible.

- III. At the original corner position set a "½"x30" alum. pipe 22" in ground with alum. cap mrk. as shown: Collar of stone.

From which: A 12" fir bears S23°E., 9.9 ft. Scribing visible.  
A 14" fir bears N20°E., 25.9 ft. Scribing visible.  
A 14" fir bears N45°W., 16.7 ft. Healed face.  
A 14" larch bears S40°W., 36.1 ft. Scribing visible.

Buried original stone alongside monument.  
Painted red bands around bearing trees.

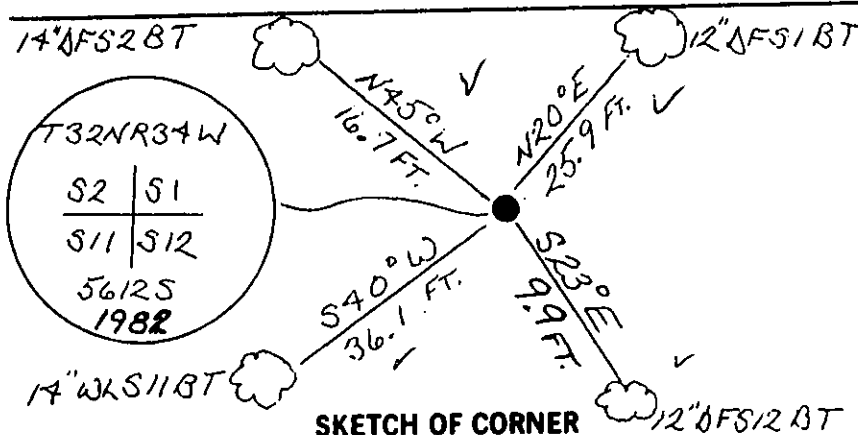
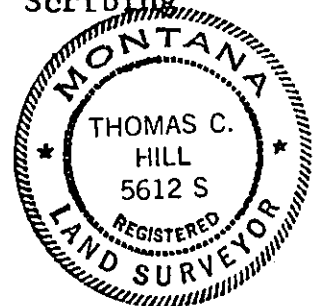

SKETCH OF CORNER

## CERTIFICATION

1. Anthony J. Bachman  
certify the information shown herein to be true and correct.  
Anthony J. Bachman  
Signature of Ground Party Chief  
2. Thomas C. Hill  
certify that this Corner Record correctly represents work performed by me or under my direction in compliance with the "Corner Recordation Act" (70-22-101, et seq., M.D.A.)  
Thomas C. Hill  
Signature of Surveyor & Seal  
Date 8-5-82 Reg. No. 5612S  
Employer: U.S.F.S.

Office of Clerk and Recorder, County of Lincoln. This "corner record" was filed for record on the Aug. 9 day of 1982 was noted on the cross-index plat and is assigned page No. 1833, in book No. Eleanor L. Vaughn by Betty L. Conner County Official deputy

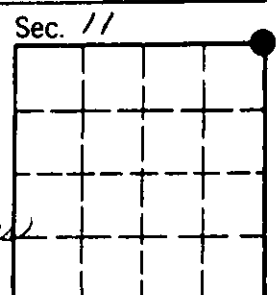

Cross Index No. E-21 T. 32N R. 34W P.M.M.

• corner this sheet

