

CERTIFIED CORNER RECORDATION

CORNER S1/4 S11 T.32 N., R.34 W., P.M.M LINCOLN COUNTY

RECORD:

Surveyed by Woodrow E. Damm, Joseph E. French, Duane G. Lindenberg,
from July 6, 1966 to August 15, 1968. Set a iron post, 30 ins. long, 2 1/2 ins.
diam., 24 ins. in the ground, with a 3 1/4 brass cap mkd.

T32N R34W
S11
1/4 S14

From which

1967

A Fir, 7 ins. diam., bears N. 281/2° E., 52 lks. dist. mkd. 1/4 S11 BT

A Fir, 6 ins. diam., bears S. 131/2° E., 45 lks. dist. mkd. 1/4 S14 BT

FOUND EVIDENCE:

A 3 1/4 inch dia. Brass Cap stamped as shown
from which:

A 8" DBH Douglas Fir no visible scribe bears N28°E 52 lks.

A 10" DBH Douglas Fir no visible scribe bears S20°W 29.7 ft. dist.

PERPETUATION:

Painted 6 inch wide bands and attached bearing tree tags and warning signs to trees.

MAGNETIC DECLINATION: 15° E

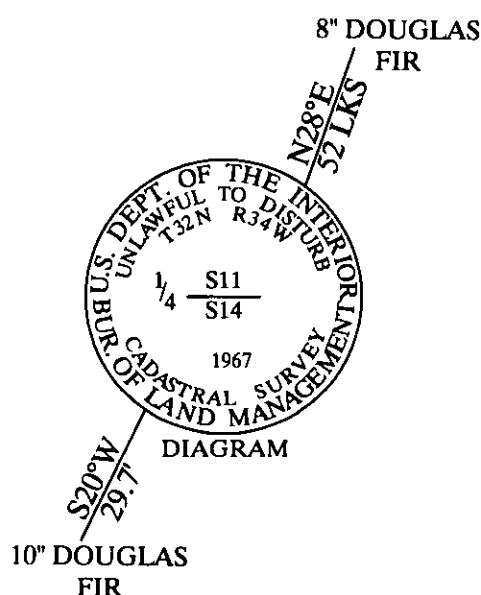

I, W. E. Damm CERTIFICATION
Certify the information shown herein is true and correct
Signature of Ground Party Chief
W. E. Damm
I, W. E. Damm
Certify that this Corner Record correctly represents work
performed by me or under my direction in compliance with the
Corner Recordation act
(70-22-101, et seq., M.C.A.)
Signature of Surveyor & Seal
Date 05/05/2011 Reg. No. 4575-S
Employer DAVIS Surveying Inc

SKETCH OF CORNER

Office of Clerk and Recorder, County of _____
This "corner record" was filed for record on _____
was not: 232466 BOOK: CCR CC&R'S PAGE: 11893 Pages: 3
No. _____ STATE OF MONTANA LINCOLN COUNTY
In book RECORDED: 05/05/2011 10:23 KOI: CC&R'S
JAMMY D. LAUER CLERK AND RECORDER
FEE: \$0.00 BY: Flavio Davis
TO: FILED
Cross Index No. J-19 T. 32 N., R. 34 W., P.M.M.

SECTION

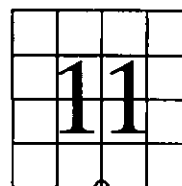

THIS CORNER

