

CERTIFIED CORNER RECORDATION

CORNER SW SEC. COR S10 T.32 N., R.34 W., P.M.M. LINCOLN COUNTY

RECORD:

Refer to the attached Corner Recordation Form Page 2704 T32N R34W

FOUND EVIDENCE:

A 31/4 inch dia. Brass Cap stamped as shown
from which:

A 13" DBH Larch no visible scribe bears N18°W 67.0 ft. dist.

A 13" DBH Larch no visible scribe bears N80°E 32 lks.

A 14" DBH Larch no visible scribe bears S75°E 25 lks.

A Dead White Pine no visible scribe bears S83/4°E 69 lks.

A 11" DBH Douglas Fir no visible scribe bears S46°W 33.4 ft. dist.

PERPETUATION:

Painted 6 inch wide bands and attached bearing tree tags and warning signs to trees.

MAGNETIC DECLINATION: 15° E

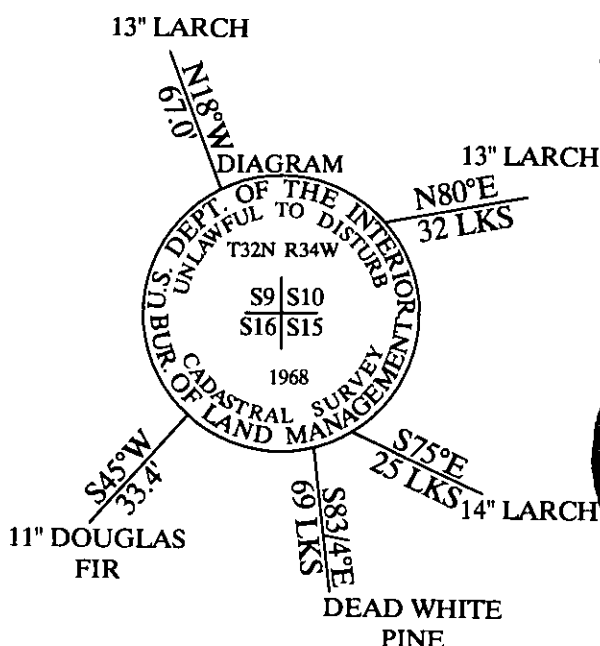

CERTIFICATION

I, [Signature]
Certify the information shown herein is true and correct
Signature of Ground Party Chief

I, [Signature]
certify that this Corner Record correctly represents work
performed by me or under my direction in compliance with the
"Corner Recordation act"

(10-22-101, Fed. Reg. M.C.A.)

Signature of Surveyor & Seal
Date 05/05/2011 Reg. No. 4975-S
Employer DAVIS SURVEYING INC

SKETCH OF CORNER

Office of Clerk and Recorder, County of _____

This "corner record" was filed for record on _____

was not 232464 BOOK: CCR CC&R'S PAGE: 11891 Pages: 4

No. _____ STATE OF MONTANA LINCOLN COUNTY

In book RECORDED: 05/05/2011 10:21 KOI: CC&R'S

TAMMY D. LAUER CLERK AND RECORDER

FEE: \$0.00

TO: FILED

BY: [Signature]

Cross Index No. J-13 T. 32 N., R. 34 W., P.M.M.

SECTION

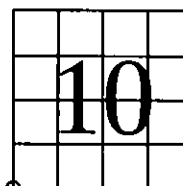

THIS CORNER